

1-1-2015

2015 Bethsaida Field Report

Rami Arav

University of Nebraska at Omaha, rarav@unomaha.edu

Carl Savage

Drew University

Nicolae Roddy

Creighton University

Gregory C. Jenks

St. Francis Theological College

Vanessa Workman

Bar Ilan University

See next page for additional authors

Follow this and additional works at: <https://digitalcommons.unomaha.edu/bethsaidafieldreports>



Part of the [Biblical Studies Commons](#), and the [History of Art, Architecture, and Archaeology Commons](#)

Please take our feedback survey at: [https://unomaha.az1.qualtrics.com/jfe/form/](https://unomaha.az1.qualtrics.com/jfe/form/SV_8cchtFmpDyGfBLE)

[SV_8cchtFmpDyGfBLE](https://unomaha.az1.qualtrics.com/jfe/form/SV_8cchtFmpDyGfBLE)

Recommended Citation

Arav, Rami; Savage, Carl; Roddy, Nicolae; Jenks, Gregory C.; Workman, Vanessa; and Bensimon, Kenneth M., "2015 Bethsaida Field Report" (2015). *Field Reports*. 13.

<https://digitalcommons.unomaha.edu/bethsaidafieldreports/13>

This Report is brought to you for free and open access by the Bethsaida Excavations Project at DigitalCommons@UNO. It has been accepted for inclusion in Field Reports by an authorized administrator of DigitalCommons@UNO. For more information, please contact unodigitalcommons@unomaha.edu.

Authors

Rami Arav, Carl Savage, Nicolae Roddy, Gregory C. Jenks, Vanessa Workman, and Kenneth M. Bensimon

THE CONSORTIUM FOR THE BETHSAIDA
EXCAVATION PROJECT
LICENSE G-45/2015
REPORT ON THE 2015 EXCAVATION SEASON



RAMI ARAV, CARL SAVAGE, NICOLAE RODDY,
GREGORY C. JENKS, VANESSA WORKMAN, KENNETH
M. BENSIMON

UNIVERSITY OF NEBRASKA AT OMAHA 2016



Figure 1, A scarab from Area A South, locus 1233, Egyptian Blue



Figure 2, Area A South, locus 1233, a Horus and Ankh



Figure 3, Area A West, Locus 2265, Ptolemaic coin, 3rd century BCE



Figure 4, Area C, Locus 5743, a bronze coin, Tyre, 2nd century BCE



Figure 5, Area A West, Locus 2298, a Black Figure Style shard showing a foot and dress, superimposed on the famous Attic Krater from Vulci signed by Clitias and Ergotimos.

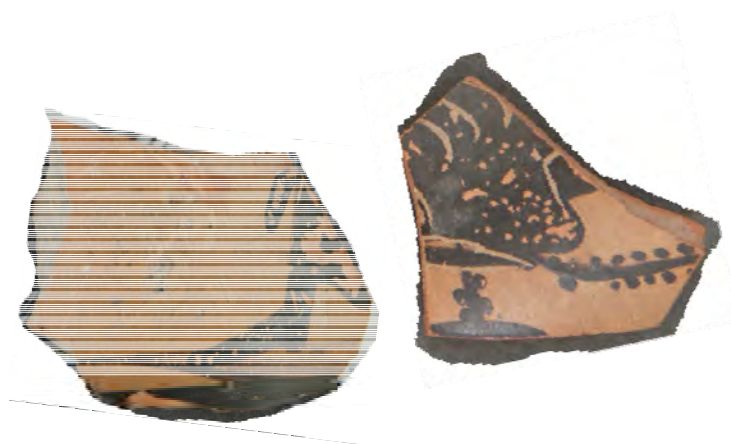

Figure 6, Black Figure shards, perhaps from the same vessel.



Figure 7, An Early Roman casserole restored by Karin Nobbs.



Figure 8, Duane Pieper worked on the new model of the Bethsaida city gate.



Figure 9, The Bethsaida team at the end of 2015 season

THE EXPEDITION

The 2015 excavation season at Bethsaida took place during May 28th to July 3rd, 2015. Seventy six faculty, students and volunteers joined this season. The expedition was hosted in Ginosar Village, Kibbutz Ginosar. We are very grateful for the kind and efficient hospitality Ginosar team and members, provides us for more than 20 years.

FACULTY (In alphabetical order)

Dr. Rami Arav, Director, University of Nebraska at Omaha

Dr. Gillian Asquith, Melbourne School of Theology

Kenneth M. Bensimon, AB, Area B Supervisor, Olympia, WA

Dr. Gloria Epps, Area C Supervisor, University of Nebraska at Omaha

Dr. Richard Freund, Project Director, University of Hartford CT
Dr. Jerome Hall, co-Director, University of San Diego
Dr. Gregory Jenks, co-Director, Area T Supervisor, Bethsaida Numismatic Curator, St. Francis Theological College, Brisbane Australia.
Dr. Harry Jol, Geophysics, University of Wisconsin Eau-Claire
Dr. Nicolae Roddy, co-Director, Area C Supervisor, Creighton University
Dr. Patrick Russell, co-Director, Sacred Heart Seminary and School of Theology
Dr. Tom Rust, University of Montana,
Dr. Carl Savage, co-Director, Drew University
Vanessa Workman, Area A South Supervisor, Tel Aviv University

STAFF

Dr. Donald T. Ariel, Numismatics, Israel Antiquities Authority
Dr. Miriam Belmaker, Zooarchaeology, University of Tulsa
Ariel Berman, Medieval Numismatics, Israel Antiquities Authority
Orna Cohen, Conservation, Jerusalem
Maha Darawsha, University of Connecticut
Christina Etzrodt, Cartography
Dr. Toni Fisher, Zooarchaeology
Charleen Green, Pottery restoration
DreAnna Hadash, Artist, Omaha, NE
Kristy Leahy, Project Coordinator
Karin Nobbs, Pottery restoration, Paris, France
Sarah Richardson, Area T Supervisor
Hanan Shafir, Photography, Israel
Bernard Trams, Pottery restoration, Washington DC

***THE FOLLOWING VOLUNTEERS ARE RECOGNIZED FOR PARTICIPATING AT THE
BETHSAIDA EXCAVATIONS FOR FIVE YEARS AND LONGER***

Miriam Gottlieb

Barry Davis

Clare James-Jenks

Karin Nobbs

Aurelia Roddy

Kelen and Emmit Wilson

CONSORTIUM MEMBERS, CLASS OF 2015

Dr. Carl Savage

Drew University

Prof. Dr. Heinz-Wolfgang Kuhn

Ludwig-Maximilians University of Munich

Dr. Gillian Asquith

Melbourne School of Theology

Dr. Patrick Russell

Sacred Heart Seminary and School of Theology

Dr. Gregory Jenks

St. Francis Theological College

Dr. Richard Freund

University of Hartford

Dr. Rami Arav

University of Nebraska at Omaha

Dr. Jerome Hall

University of San Diego

Dr. Miriam Belmaker
University of Tulsa

Dr. Walter Bouzard
Wartburg College

THE EXCAVATION

A total of 50 loci were excavated in 2015.

Area	Location	Grid	Loci numbers
A South	South of Stratum V city Gate	L, M, N, 58, 59, 60	1221-1238
A West	West of A South,		2290-2308
B	East of the Bit Hilani Palace, the slope of the mound	L, M, N, 41, 42	3000-3001
C	North section of the mound	ZZ, YY, C, 28, 29, 30	5738 - 5744
T	The southern slope	A, B, C, D, 68, 69	4018 - 4025
Total loci			50 loci excavated

Since Bethsaida is located below Sea Level all elevation numbers in this report are negative unless otherwise stated.

Area A South



Area Supervisor: Vanessa Workman

Stratum VI

Loci report

Loci: 1221, 1223, 1233, 1235, 1238

This year we continue the search for the city gate of Stratum VI. During the years we've had clues indicating the location of the gate. We discovered that Stratum VI city gate is not located under the massive Stratum V, four chamber city gate, but rather further south in squares: I, J, K L, M 58, 59. The actual entryway is perhaps buried under Stratum V city wall (W 1186). This wall is 6 m. wide and on top of it runs Stratum II (Roman) city wall of 2.5 m. wide. This makes the removal of the walls an unworthy endeavor.

A remnant of a wall (W 1197) that extended from the outer city wall (W 1185) and in the season of 2014, was thought to be part of it, turned out to be an addition of Stratum V. It is located 27 cm. above Stratum VI pavement abutting the outer city wall. This wall was removed and a packed dirt floor of Stratum VI was discovered under it.

The apparent entryway to the gate was made of packed dirt floor that slightly slopes down to the ravine from an elevation of 172.63 to an elevation of 173.15 m. on a distance of about 4 m. It means a gradient of 0.78 m on a distance of 4 m. A wall (W 1198) was discovered at the southern end of the Area A South and might be connected to the city gate structure. Large stones were built on the outer face of the wall, indicating that it was part of the defense system of the city gate of Stratum VI.

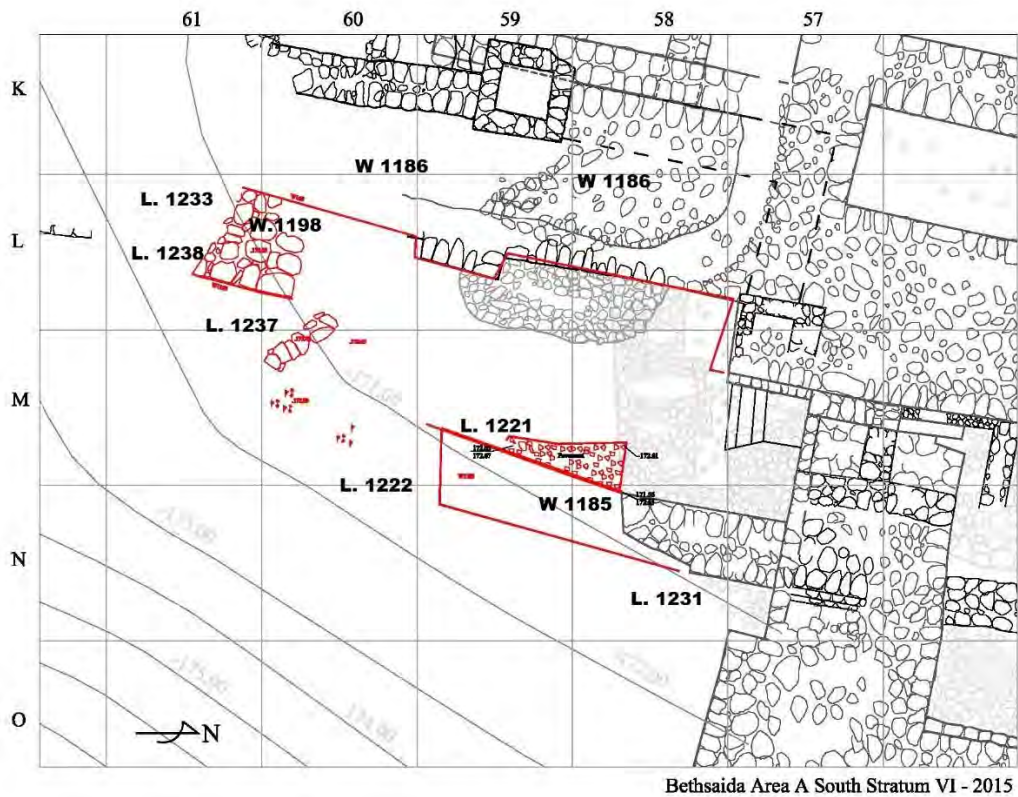

Figure 10, Area A South, Stratum VI



Figure 11, W. 1197 is Stratum V and situated 27 cm above the pavement of Stratum VI. This wall was added in Stratum V to block the gap in the outer city wall where the entryway of Stratum VI had been.



Figure 12, Wall 1198. Notice the gap between Stratum V pavement (upper right hand side of the picture) and the top of W. 1198. The scale is resting on boulder forming the face of W1198. A second course is seen under that rock.

Finds from this stratum include a scarab in "Egyptian Blue" soft stone showing ankh and a Horus with one wing sheltering the Ankh (cover picture and figure 1, 13).

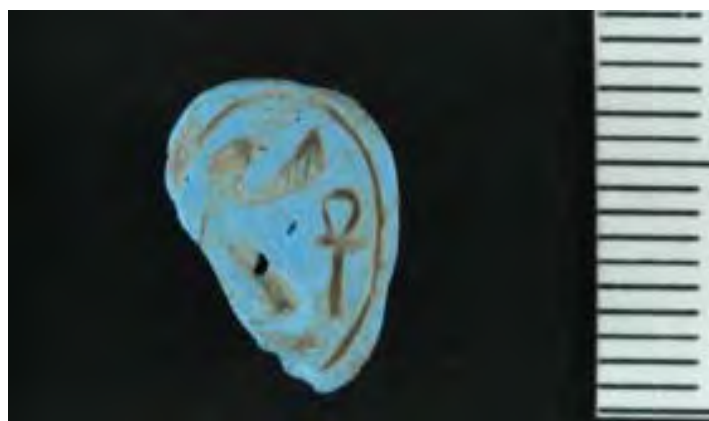

Figure 13, Area A South Locus 1233, "Egyptian Blue" scarab depicting ankh and horus.

Only few diagnostic pottery shards dating from the 10th century BCE, were discovered at Stratum VI.

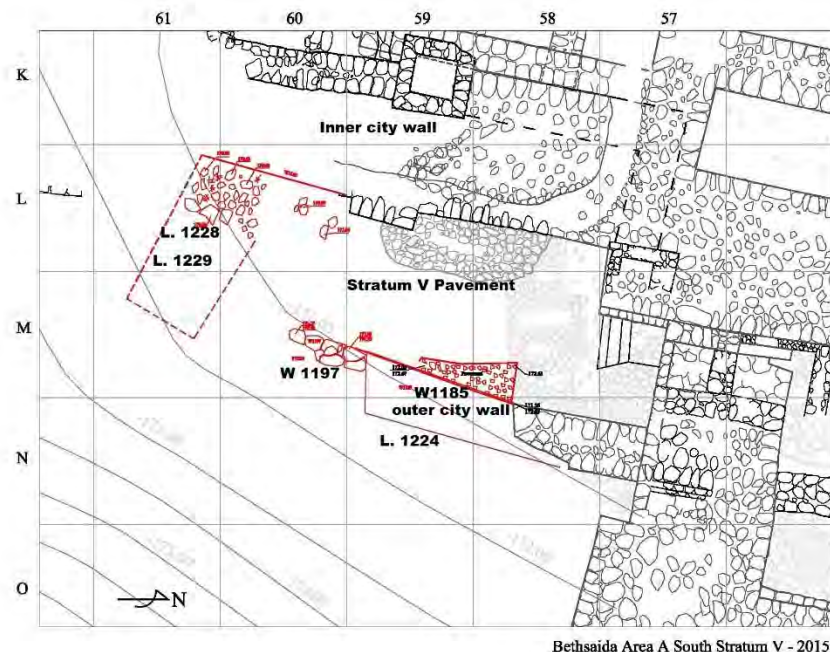

Figure 14, Finds from Stratum VI, upper row: Cooking pots, lower row, a ring base of a bowl, Iron Age IIA, this locus is mixed locus with Iron Age IIA to Roman period pottery. The shards in this picture date from the Iron Age IIA.

No sign of fire was discerned in the debris of W 1198 and no ashes were found on the packed floor east of the presumed entryway and the loci associated with Stratum VI gateway. However, layers of debris made of broken bricks, plaster, stones and rubble were found in the space between the pavements of Stratum VI to Stratum V. This has been recorded already in last year's report. Therefore, the reasons for the destruction of Stratum VI remain unknown. However, Carbon 14 dating of Stratum VI yields the date of 920 BCE with probability of 65%. Apparently, and different from our previous publications, Stratum VI was destroyed around this date. There are a few candidates to this destruction. One is the campaign of Shishak which recorded cities in the north such as Ta'anakh. Another contenders are the Aramean kings of Damascus or even earthquakes. The fact that the city was soon after rebuilt in a different design may suggest a human factor rather than natural disaster.

The construction of Stratum VI remains also elusive. The date suggested in the past was early during the 10th century BCE. This date seems to be the most plausible date.

Stratum V



Loci: 1225, 1230, 1232

The pavement of Stratum V continued to the south. This pavement is located between the outer and the inner city walls.

Locus 1225 consists of removal of top soil that contained modern, medieval and Roman and Hellenistic deposits. After these had been removed, finds from Iron Age IIB were discovered.



Figure 17, Finds from locus 1225 top soil include modern glass, medieval glazed pottery and some Hellenistic shards.



Figure 18, Upper row from left, Iron Age IIB bowl, Hellenistic cooking pot, Hellenistic jug, Iron Age IIB jug, third row from left Early Bronze Age II shard, Medieval, Early Roman cooking pots, Hellenistic bowl.

Loci 1229, 1230, 1232

These loci were excavated under the floor of Stratum V and contained Iron Age IIB material. The Stratum V city wall (W1185) was exposed in this locus.



Figure 19, Inner city wall W1185 is at west side of Locus 1229. Notice that unlike other segments of the inner city wall, these were made of small stones and mortar.



Figure 20, Iron Age II finds from Stratum V.

Stratum II

Small finds from Stratum II were discovered in the top soil and in the eastern end of Area A South. Since no architecture associated with Stratum II was found, but deposits of small finds, the assumption is that during the Hellenistic and Roman periods, the inhabitants of Bethsaida hurled their waste outside the city walls that in several sections were still standing to a considerable level.



Loci 1224, 1228, 1229, 1231,

Locus 1224 is located at the east end of Area A South. It consists of a cut in the previous strata and a fill of small stones pottery shards and debris. Most shards are Hellenistic and Roman.



Figure 21. Locus 1224, Early Roman cooking pots, oil lamp, Iron Age IIB cooking pot and flint sickle blade.

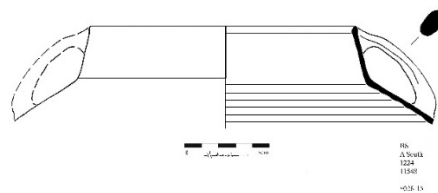

Figure 22. Early Roman Cooking pot

Loci 1228, 1229 are extension of Area A South to the south. The loci contain Roman period shards of pottery.



Figure 23. Shards of pottery range from medieval glazed pottery to the Roman period.

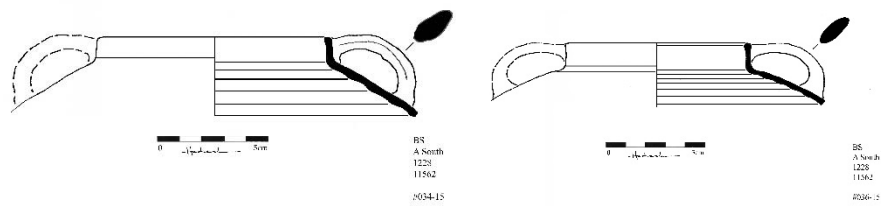

Figure 24. Early Roman cooking pots

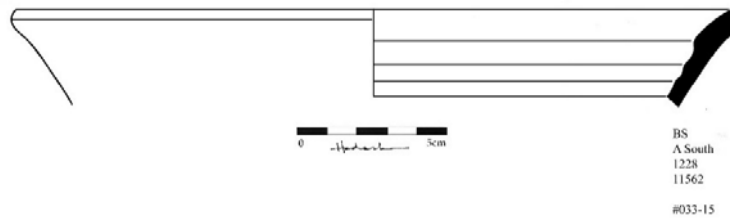

Figure 25. "Galilean Bowl"



Figure 26. Roman period shards of cooking pots together with Iron Age IIB and medieval glazed shard.

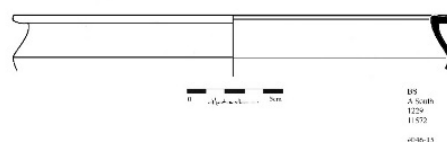

Figure 27. Early Roman casserole

Area A West



Figure 28. Area Supervisor Dr. Carl Savage

Loci: 2290 – 2309, squares: G, H, I, 58, 59

Stratum V

The excavation season of 2014 revealed a paved structure in square 59 H. The southern end of the pavement was destroyed by collapse of large stones. Within the collapse there was an upstanding stone that in the previous season was thought to be a possible stele. During the 2015 excavation season it became apparent that the upstanding stone is part of the collapse. The entire locus (L. 2308) had been removed.

Interestingly enough, the pavement and the E-W wall (W 1196) abutting it, does not intersect with the nearby N-S wall, (w 1195) but a gap of about one meter between the two (locus 2294) was found once the debris of the walls was removed. The purpose of this structure is still unknown.



Bethsaida - Area A West - Stratum V -2015



Figure 29. The paved area Locus 2301. Notice the passage (L. 2294) between the pavement (L. 2301) and the wall at the west (W 1196). The passage leads to the courtyard in front of the storage house.



Figure 30. The paved floor at L. 2301. Notice that the floor ends with four larger stones and lining up with wall, W 1196 creating a passageway L. 2294.

Stratum VI

Loci 2302, 2307

Is situated east of the paved structure and revealed patches of limestone crashed packed dirt, of several superimposed floor. The second floor was discovered in an elevation of 170.02 m. Animal bones were also discovered in the area. The purpose of this area is still unclear although the general notion is that it served as a cultic area.



Figure 31. L. 2302, a few patches of red packed floor are seen in the center of the picture.



Figure 32. Pottery from L. 2302 includes clear Iron Age IIA / Iron Age I pottery shards, a jar handle with reed impression and a red slip on rim bowl.

Locus 2307

This locus is located under L. 2302. Both loci are under the foundation of W 1196 and therefore are designated to Stratum VI. A few patches of floors are revealed, the top is red material, crashed red bricks and the lower is made of crashed limestones.



Figure 33. Crashed limestone floor is located under the red material floor. These loci, L2302 and 2307 are designated as Stratum VI because they appear under the foundation of Stratum V, W 1190. The loci south of these loci, shown in the left side of the picture are modern disturbances.

A few diagnostic shards of pottery and a few bones were discovered on the floors.



Figure 34. Iron Age IIA pottery shards. A red slip bowl and a neck and a rim of a jar.



Figure 35, Bones from L 2307

Stratum I-II

Other loci of Area A West are located in the south part of the area and are mildly or severely disturbed. No substantial architecture was discovered in these loci, instead there were scattered large boulders and stones. The find from these loci represent all periods of the site.

Locus 2292 in square G59, included a fragment of a Roman period beaten earth floor. Under the floor remains of a Hellenistic oven were discovered.



Figure 36. Remains of an oven in Locus 2292



Figure 37, L. 2293. Scattered stones and patches of floors in a severely disturbed locus.

Below are a few examples of finds from these mixed loci. Some of the finds are unique and exceptional.



Figure 38. Locus 2290, Iron chisel, and pottery shards from the Hellenistic period and medieval glazed Mamluk shards.



Figure 39. L. 2290. A medieval "hand grenade". L. 2290 is located in G59 and is disturbed locus.

Locus 2293 contained patches of packed floor in an elevation of 169.44, but the pottery on that floor was mixture of Medieval to Iron Age IIB.



Figure 40. Locus 2293. The shards contain Iron Age II B jar, a stopper, Iron Age II B carinated bowl, Iron Age IIB cooking pot. The shining shard is most probably a Roman period "Apulian" ware.

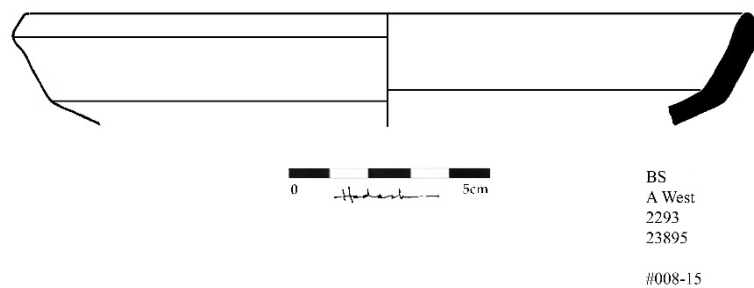
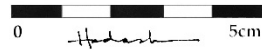
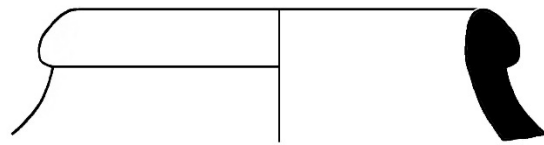

Figure 41. Locus 2293, An Iron Age IIB carinated bowl



BS
A West
2293
23895

#006-15

Figure 42. Locus 2293, Iron Age IIB jar

Locus 2296 is located east of W 1195 and features a disturbed area with finds from all periods of the site.



Figure 43. Locus 2296. Shards of pottery from all period represented at the site.

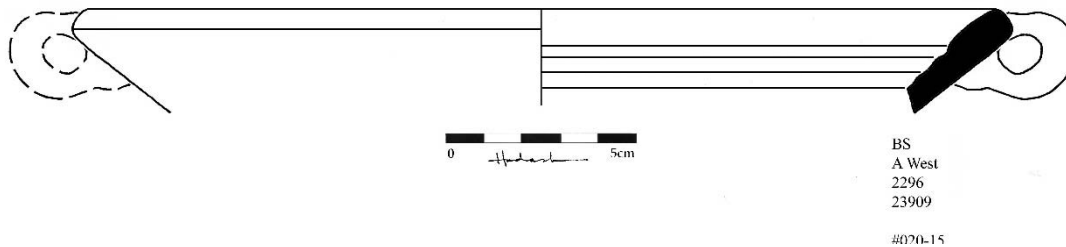

Figure 44. Locus 2296, Galilean bowl with a small handles.



Figure 45. Locus 2296 contains Iron Age II B jar, black glazed ETS and medieval pottery.

Locus 2298 is located south of the paved area and contains debris of large and medium size rocks. The pottery shards retrieved from this locus includes all representatives of the occupation at the site.



Figure 46. Locus 2298 is immediately south of the paved area of locus 2301. It contains scattered stones.

Outstanding is a shard of pottery in Black Figure Style. This style was common in Greece until the mid-sixth century BCE, however, this style continued to be in use in Panathenian amphorae and in some lekythoi designated as funeral offerings. This shard is apparently a fragment of a lekythos. Another Black Figure shard was found a few years ago and may have been part of the same vessel.

body shard scan

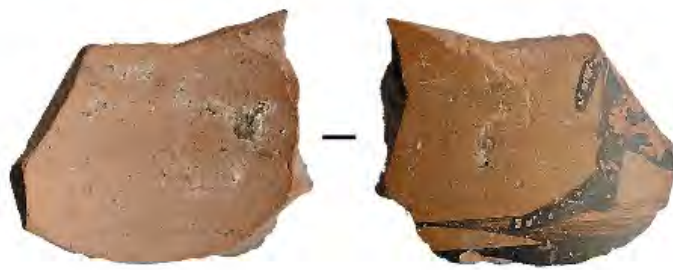

interior

exterior

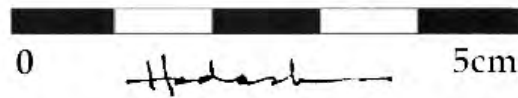

BS
A West
2298
23967

#021-15

Figure 47. A shard of pottery in Black Figure Style depicting a foot and a segment of a garment. Perhaps a Lekythos.



Figure 48. A Black Figure Style shard



Figure 49. This shard is of a high artistic quality and is here compared with the famous François Vase, dated from c. 560 BCE, signed by Clitias and Ergotimos.

AREA B

Area Supervisor: Kenneth Bensimon



Area B excavation project aims to dig what seems to be, an escape tunnel leading from the northeastern room of the palace to the area in between the two city walls. It is named the Bethsaida Escape Royal Tunnel (BERT). A generous donation by Kenneth Bensimon made this excavation possible.

The excavation was carried out by a group of Druz workers who did an excellent work.

Ken Bensimon helped with this report:

Datum: BM 167.02 (the inside of the inside wall - North of the Syrian trench 5 M).

Beginning to cut a 10 m. wide section from the west known tunnel entrance and to the suspected outer face of the inside city wall to the East.

The intent of the section was to expose the outside face if the inside city wall.

Finds: typical military debris from the 1967 war. Other findings; brick pieces, sling stones, and mixed period pottery shards.

The face of inside city wall was discovered 6.25 m. from inside face, and about one m. deep from the existing surface. The wall creates a line parallel to the inside face. This width of the wall complies to the other discovered segments of the city wall.

Finds: Iron Age II pottery.

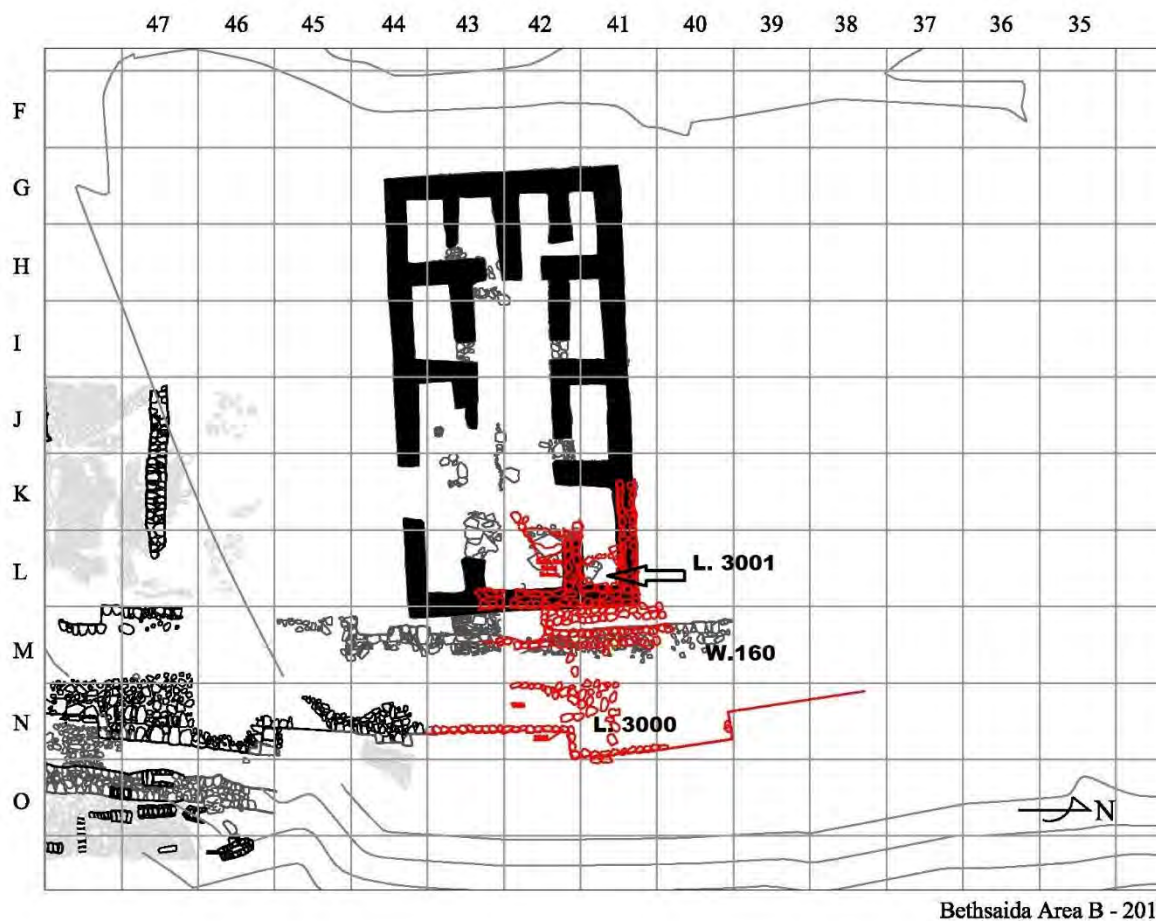

Bethsaida Area B - 2015

Figure 50. The Bit Hilani palace, the red is the 2015 excavation season.

2-7-15
Thurs.

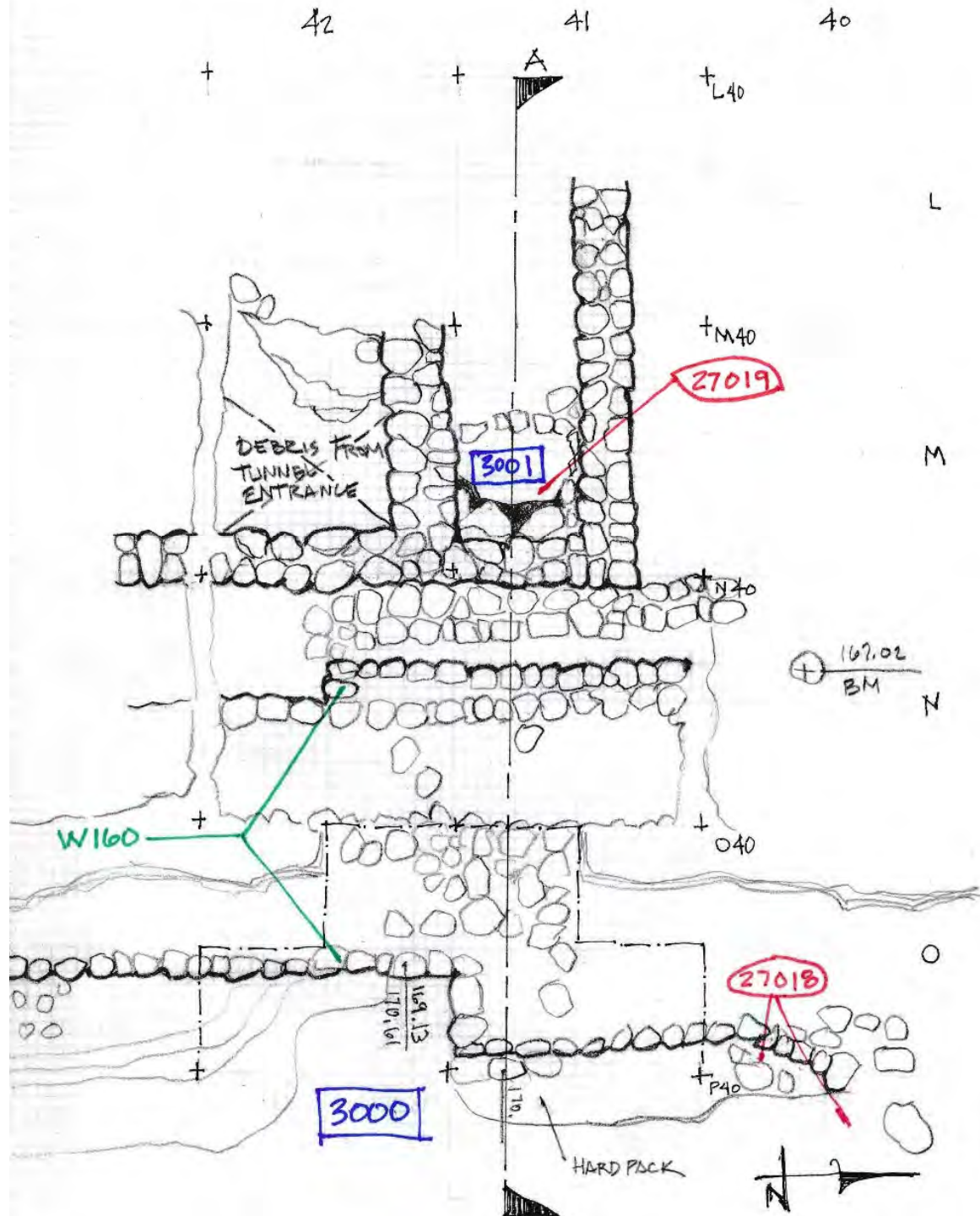
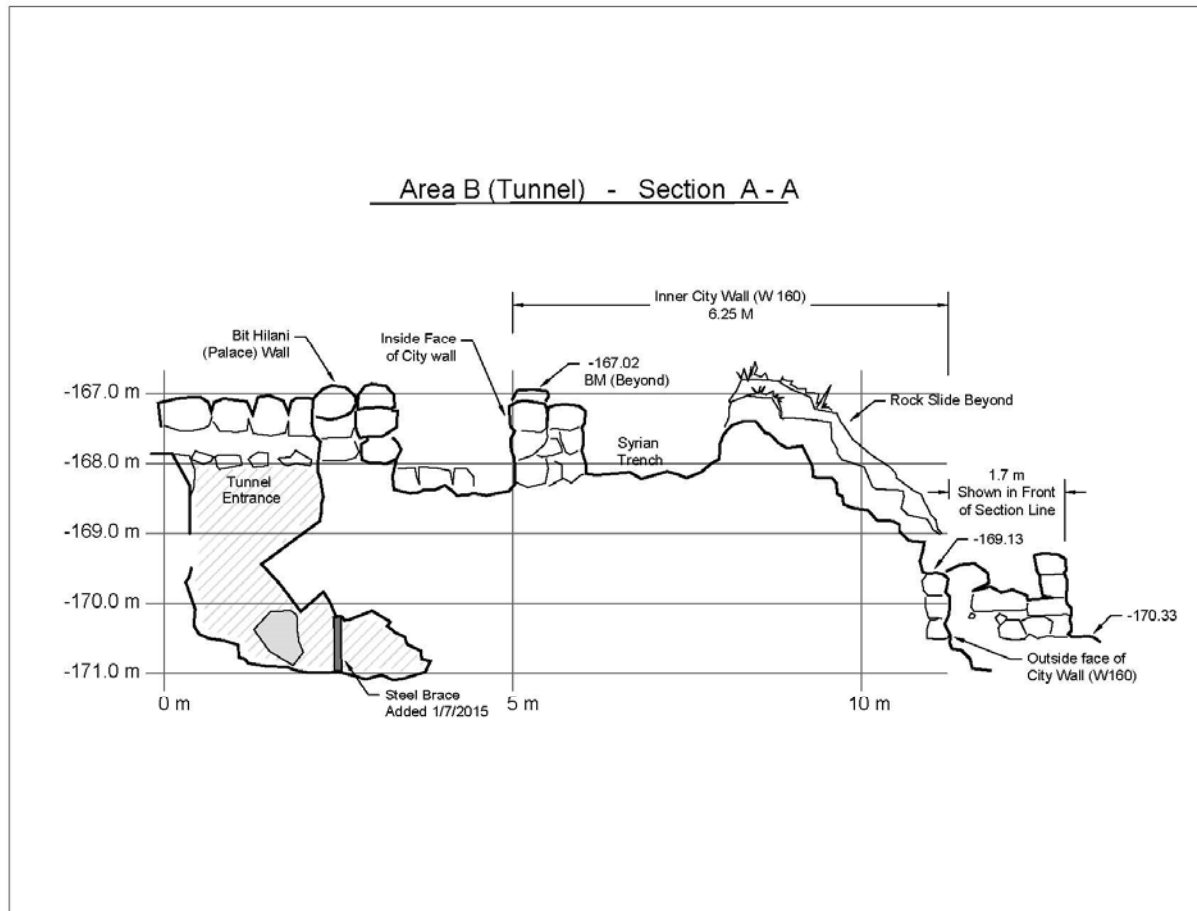

Figure 51, Area B field map.



Bethsaida Area B Tunnel - 2015

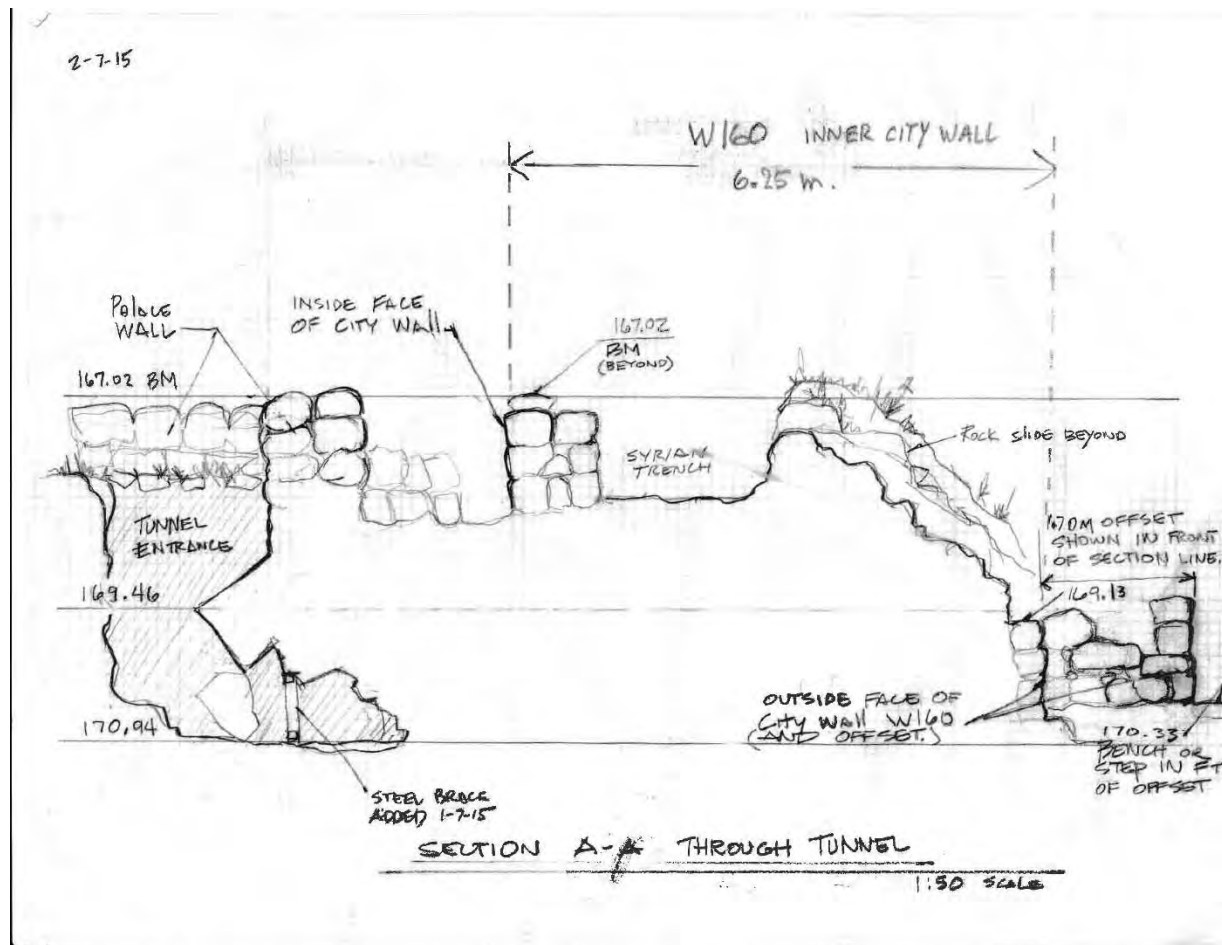

Figure 52. Area B, section A-A looking north. Notice the size of the city wall W160. A modern Syrian military trench was excavated into the wall, field log.

The entrance to the tunnel was discovered in 1994 when the Bit Hilani palace was unearthed. However, digging it required skilled engineering efforts which Ken Bensimon kindly offered to the expedition. Ground Penetrating Radar tests done in the past, revealed a possibility of a tunnel leading from the northeastern room of the palace under the city wall. The plan was to find the outer city wall in order to see if there is an entrance or not. Two loci were excavated, locus 3000 is a section of the city wall (W160) and locus 3001 is the entrance to the tunnel at the palace.

The city wall (W160) was 6.25 m. wide and had been built similar to the other segments of the excavated city walls. Opposite to the northeastern room of the palace, an offset of the city wall was discovered which created a tower. The offset projects 1.7 m. off the city wall line and is roughly parallel to one meter offset in the inner face of the city wall. The entire

length of the tower has not been found yet. Two stones in front of the offset may have been a bench or a small high place. Further excavations in this area need to be done in order to find out the purpose of it.



Figure 53. The projection on the city wall (W160). The horizontal scale lays on two stone adjacent to the projection. The purpose of these stone is still unknown.



Figure 54. The projection off the city wall W160 marks a tower built into the city wall. Notice the two stones adjacent to the corner of that projection. This projection is echoed

by a projection on the inner face of the wall. Both projections make the width of the tower 8.5 m. wide.

This tower is situated 20 m. north of another tower excavated some years ago. This distance is perhaps an ideal for archers protecting the city wall from the towers. The length of the tower is not yet discovered.



Figure 55. The city wall (W160) is in the center of the picture where the state of the preservation of the city wall is more than one meter high. The distance between the two towers is 20 m.

Finds from this locus include modern artifacts on the first layer and under this deposits Hellenistic and Roman period finds were found. Most of the finds from these period most probably originated from waste thrown over the city walls down into the slope.



Figure 56. Pottery shards from the Hellenistic and Roman periods include a Megarian bowl, red slip ETS, and Iron Age shard.



Figure 57. Megarian shard of pottery showing a palmate.

Locus 3001 is the entrance to the tunnel from the within the northeastern room of the palace. Only about one meter of the tunnel is excavated in the tunnel. In the next year we plan to dig more in this locus.



Figure 58. The entrance to the tunnel.

The finds from locus 3001 were thus far very few and contain Iron Age II B pottery shards.

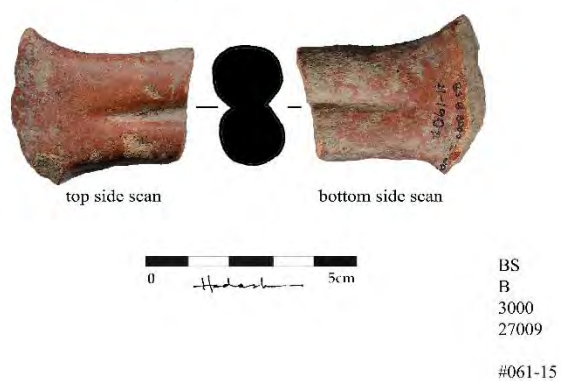

Figure 59. Cypro-Phoenician handle of a jug.

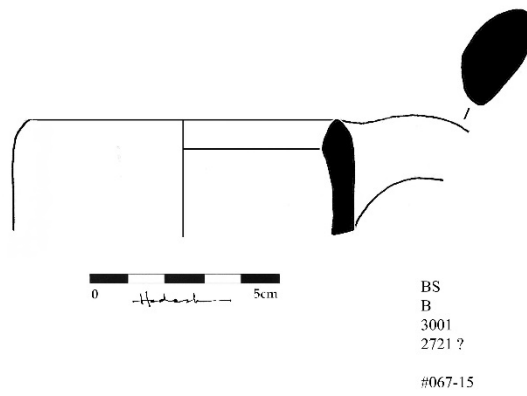

Figure 60. An Iron Age II B jug

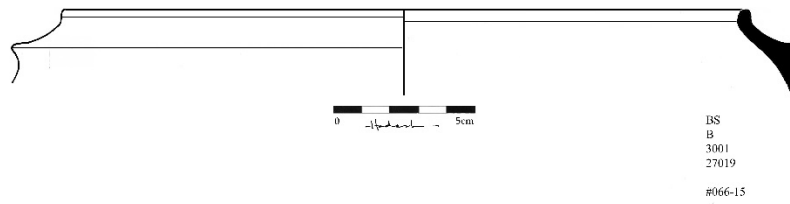

Figure 61. An Iron Age II B cooking pot

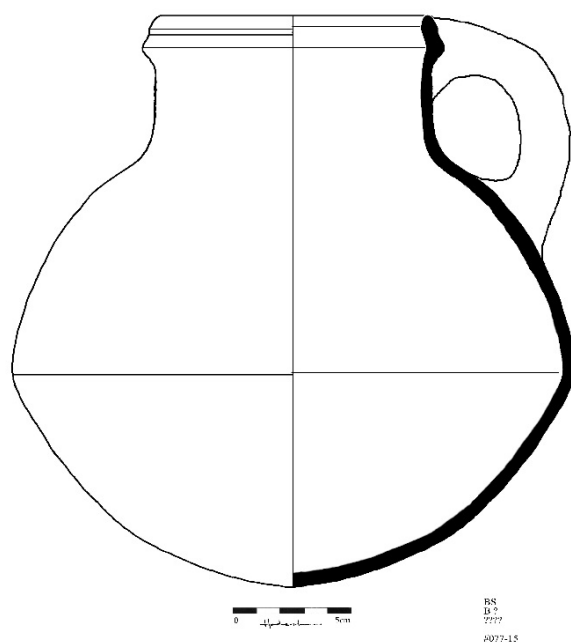

Figure 62. An Iron Age II Cooking pot from the palace.

Area C



Figure 63, Area Supervisor, Dr. Nicolae Roddy



Figure 64. Area C, patches of the paved street and a segment of a structure at the right center of the picture, near the scale stick.

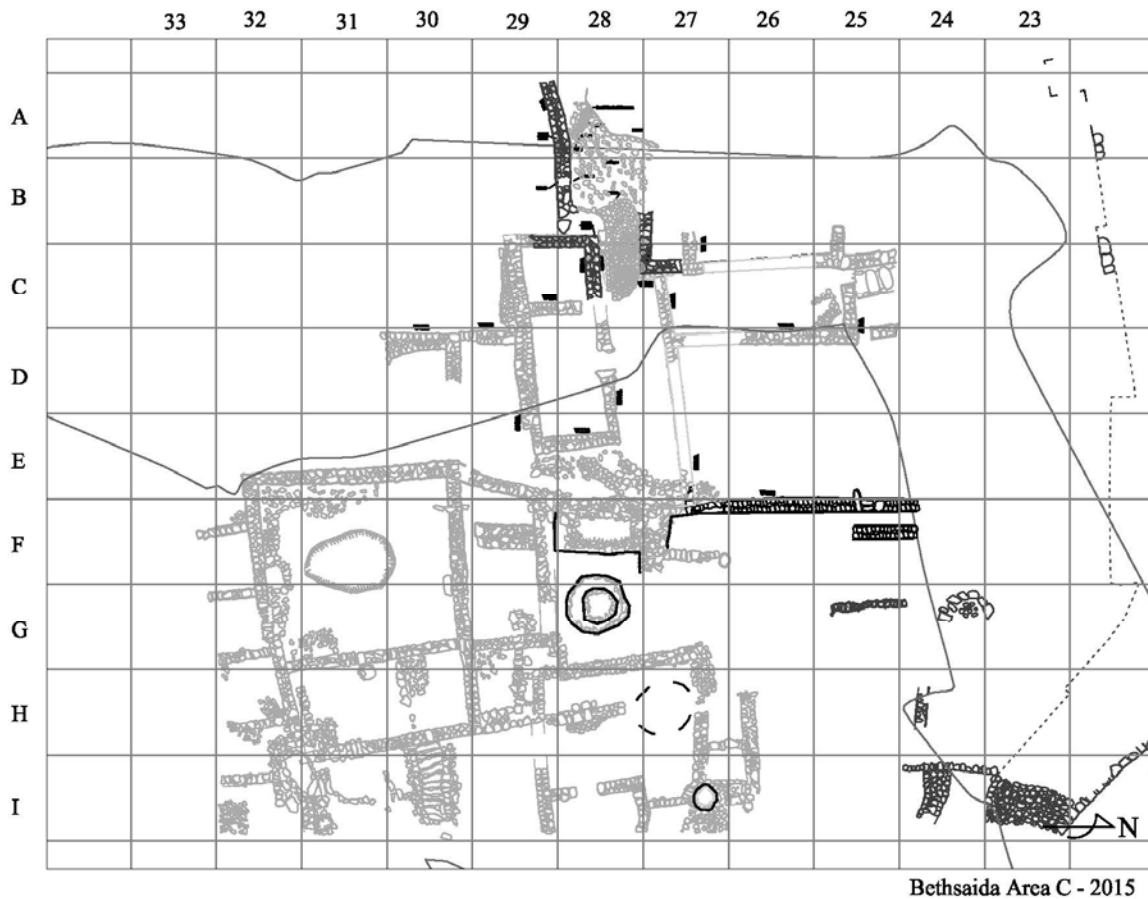

Below is the report of Dr. Roddy:

AREA C

Supervisor: Dr. Nicolae Roddy, assisted by Emmit Wilson

Area C, located at the northern end of the mound, was excavated from June 22–July 3, 2015. Excavations continued exposing the lower end of the east-west pavement in grid ZZ 28/29, while a probe was opened in a northern room of a courtyard house in D 29. Excavations at the lower end of the paved pavement, which opens to what appears to be a wide public area, revealed a bracket-shaped structure opening toward the east, with an interior area measuring about 1 m. square and with walls 1 m. thick (Fig. 66). The structure's size, shape, and eastward placement in the middle of the open area suggests a shrine, showcase, or perhaps a podium for public address. Unfortunately, the anticipation of uncovering more of its context next year is somewhat dampened by an adjacent modern Syrian trench cutting off the larger open area.

Moving now to the probe in a northern room of the courtyard house (D 29), a north-south wall measuring 80 cm in width was discovered (W 1350). Following the wall, excavations revealed that it connects with existing W 219. Area C finds include four coins, a decorated Hellenistic oil lamp, a fishing weight, two beads, a flint blade, and a complete iron nail.



Bethsaida Area C - Stratum 2 - 2015

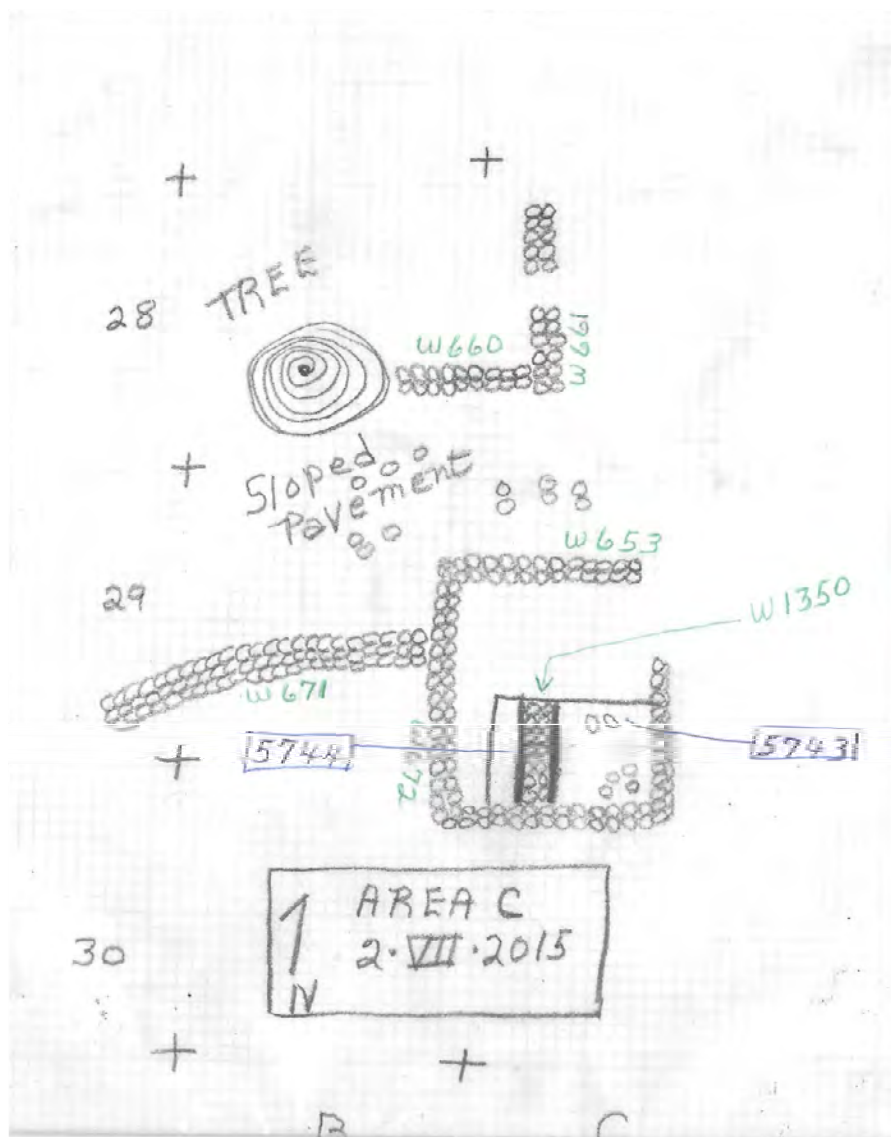

Figure 65. Area C. Notice loci 5744 and 5743 in both sides of wall W 1350. Field log

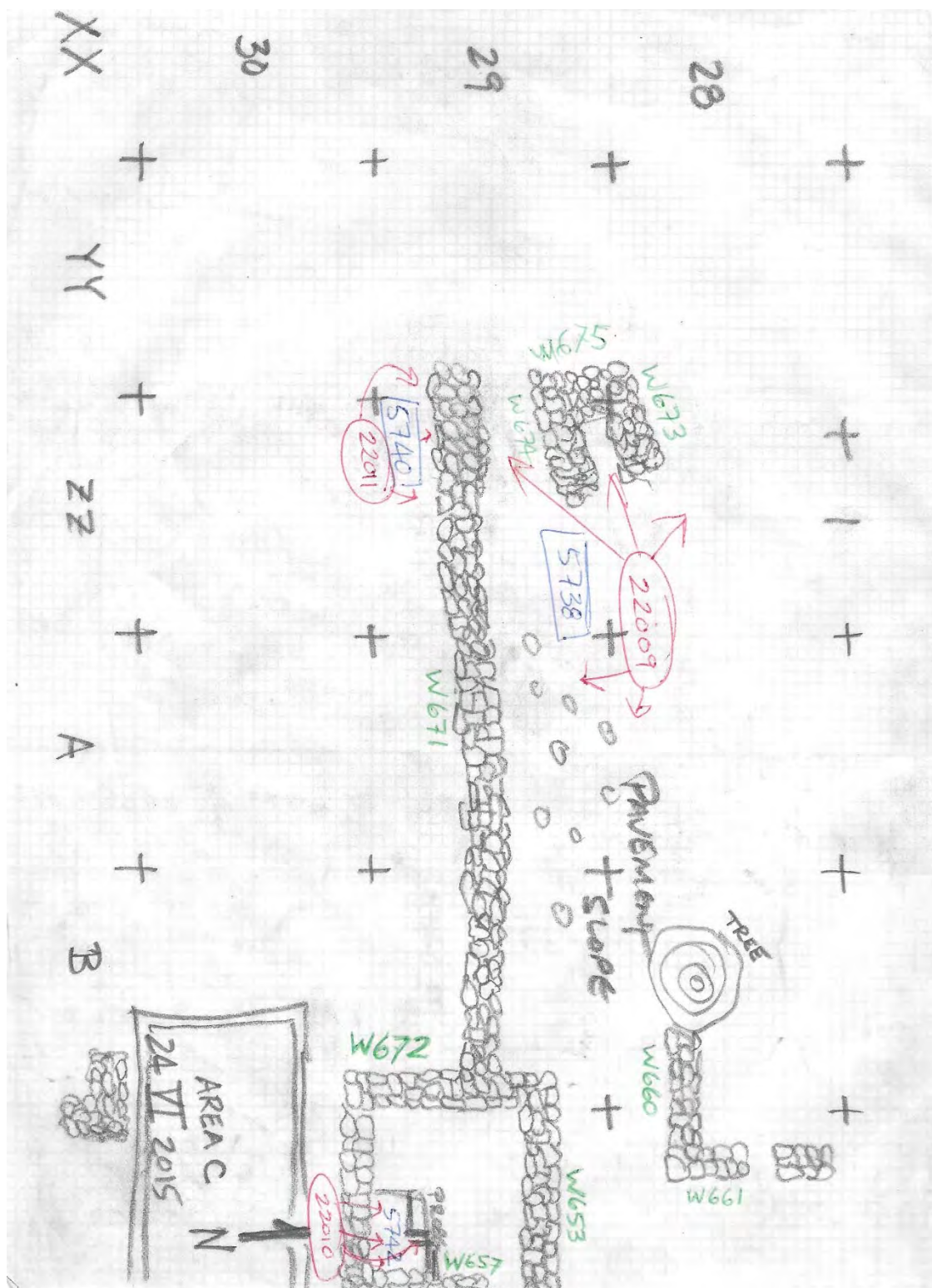

Figure 66. Area C. Locus 5738 consists of patches of pavement and scattered stones slopes down towards the west. A structure consists of three wall (W 673, W 674, W675) and a wide opening to the east was found north of wall W 671. The purpose of this structure is yet unknown. See above the area Supervisor's suggestions.



Figure 67. Area C, a probe in the "clinic". Locus 5743, wall W 1350 and Locus 5744.



Figure 68. Area C, locus 5742, a probe in the "clinic", finds include a Rhodian wine jar and Hellenistic and Roman cooking pots.



Figure 69. Area C Locus 5738, Hellenistic pottery including Rhodian wine jar shards and Spatter Washed pottery.



Figure 70. Hellenistic, Early Roman, Spattered Washed Ware with “fork” impressions



Figure 71. Area C, Locus 5740, located south of wall W671. It contains mixed pottery, Hellenistic ware, ETS, flints and EB II combed ware.



Figure 74. Area C, Locus 5744, Hellenistic oil lamp with radial design.

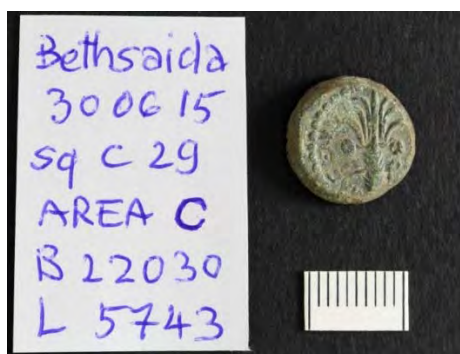

Figure 75, A Seleucid coin, second century BCE

Area T



Figure 76. Area T Supervisor Dr. Gregory Jenks



Figure 77, Area T Assistant to Area T Supervisor, Sarah Richardson

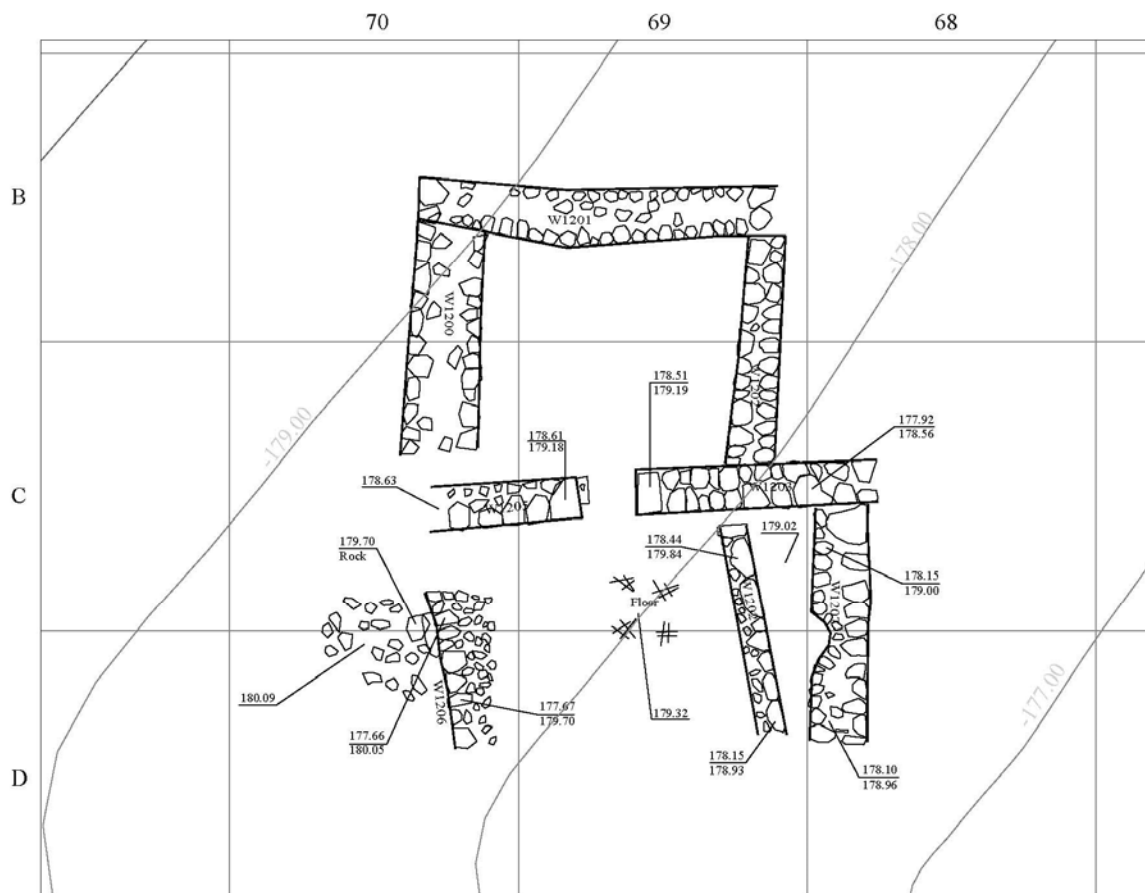

Bethsaida Area T - Stratum 2 - 2015

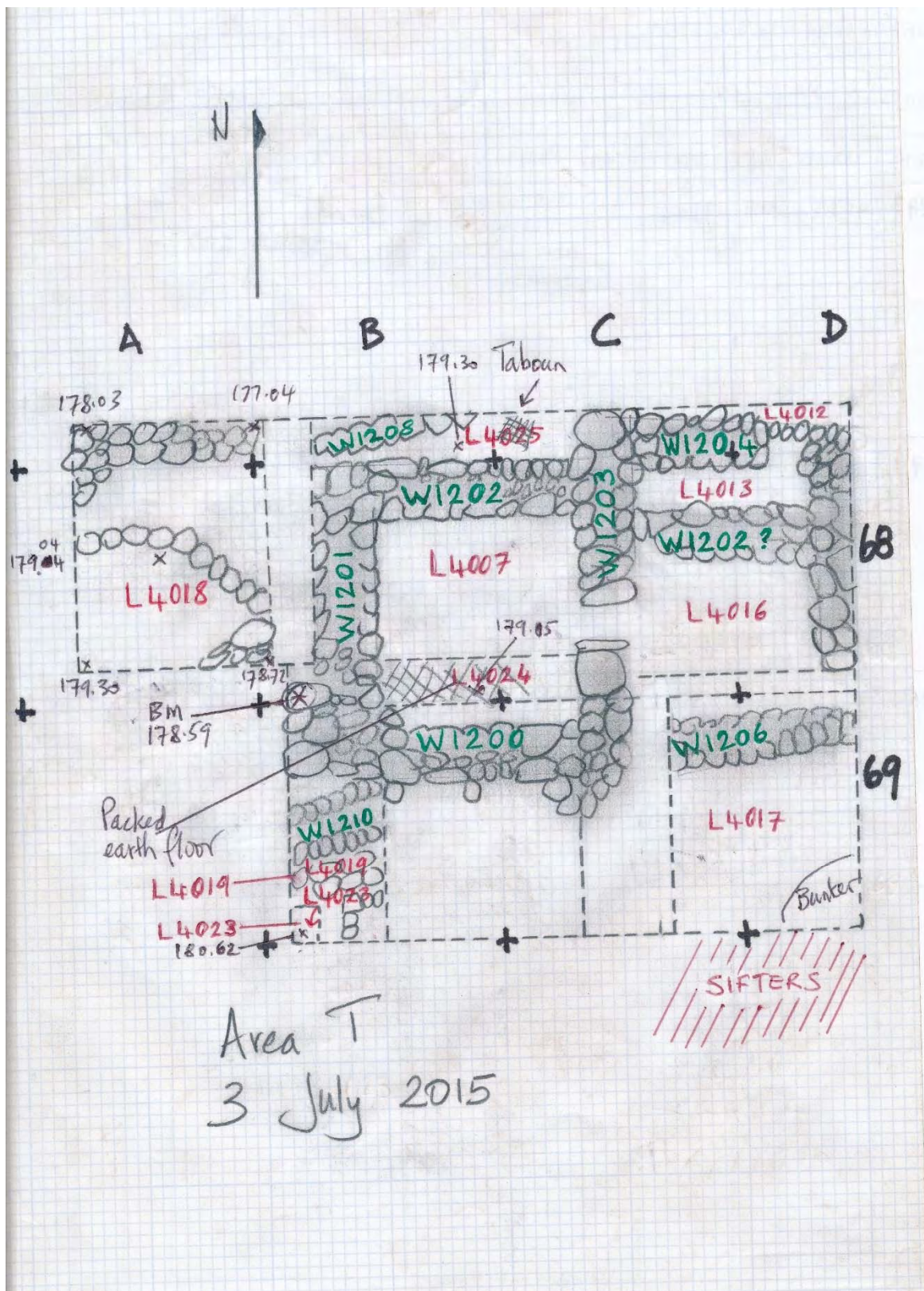
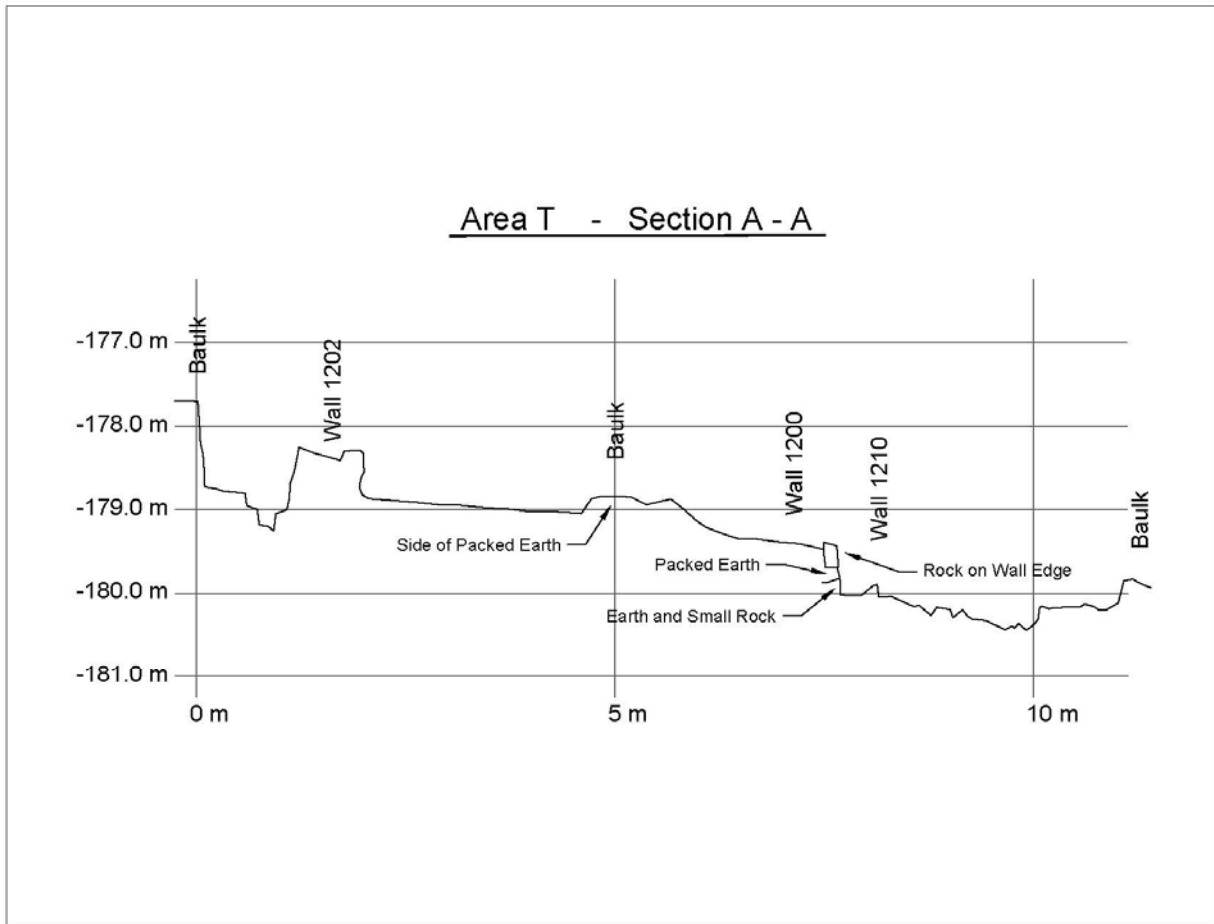

Figure 78, Area T, field log



Bethsaida Area T - Stratum 2 - 2015

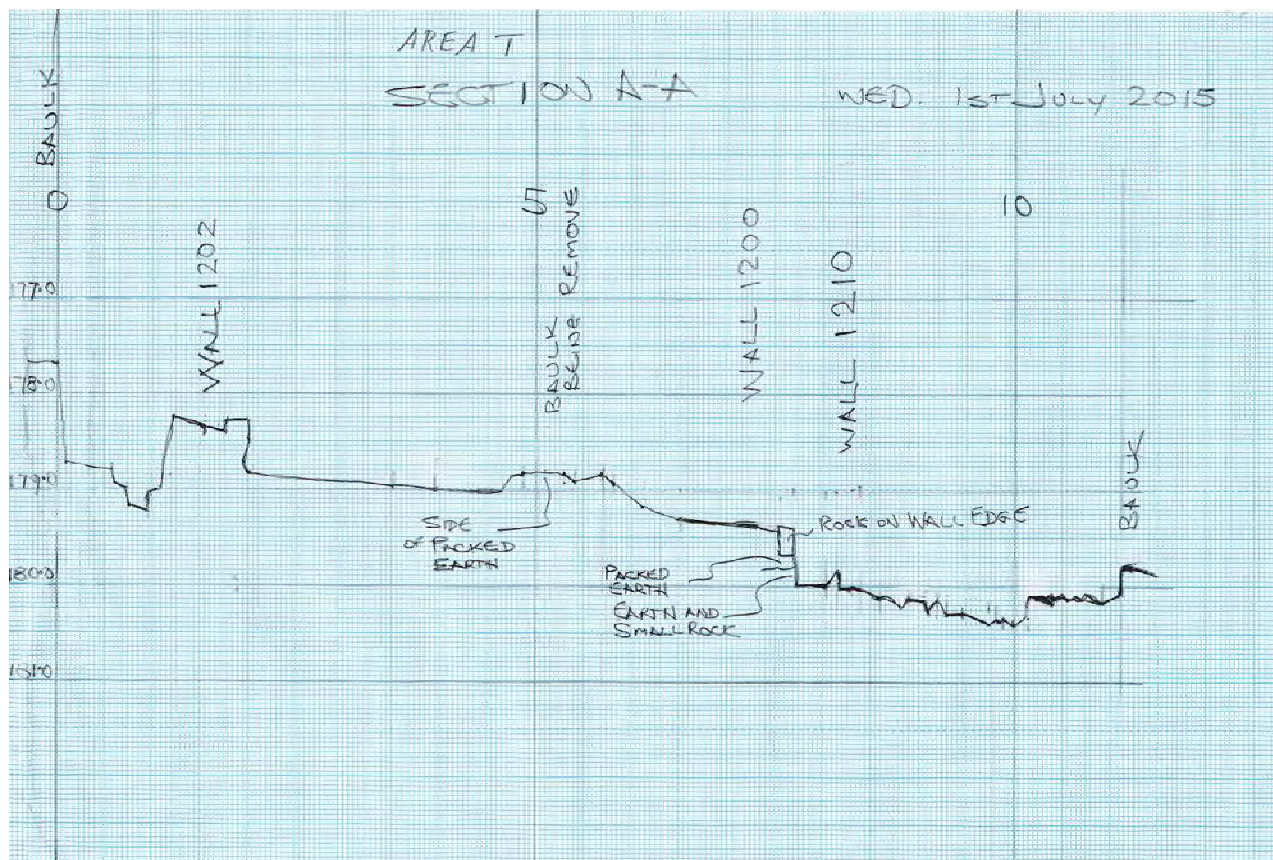

Figure 79, Area T Section A-A, looking east, field log.

Area T is located on the southern slope of the tell and was first opened in 2012. During the 2015 season the area was opened only for the final two weeks of the season. A new square (A 68) was opened to the west of the squares first opened in 2013, we removed the baulk between the squares (B, 68, 69) opened in 2012 and 2013, and we opened a probe at the western edge of the original square (B 69) from 2012.

Removal of the baulk exposed fully the lower courses of a 5m x 5m stone structure (W1202, W1201, W1200, W1203), which is thought to be an interior room of a domestic space from the Mamluk period. It has an interior door on the eastern wall that leads to an adjoining room of the same structure (W 1203). North of the room now fully exposed for the first time we found hard packed floor and an oven (Locus 4025). This confirms the domestic character of the stone structure.

The new square opened to the west of the existing excavations (A 69) did not reveal any significant finds. It is possible that we have the remains of a wall running east/west

on the northern edge of the new square. In the center of the square there is a curved arrangement of field stones that will require further excavation in future seasons.

A 1m x 1m probe in the original square (B 69, Locus 4019) was opened to ascertain what might lie beneath the level reached in earlier seasons. It revealed an underlying stone structure, most likely a wall (W 1210), running at an angle that would intersect with the line of the previously exposed Mamluk structures, and separated from the later structures by about 20 cm of soil. Mamuk pottery from this probe suggests that the structure exposed in the probe was from an earlier phase of the Mamluk period. The probe was expanded to 2m x 1m in order to continue exposing the earlier material in the south-west corner of the square, and it revealed further stone structures, with some worked stones suggesting a door or window.



Figure 80. Area T, Locus 4018, looking south.



Figure 81. Area T, probe, Locus 4019, showing wall W1210 runs in east west direction and is situated below a Mamluk structure.



Figure 82. Area T, Locus 4020, north of the Mamluk wall W1202.



Figure 83. Area T, Locus 4020 looking south



Figure 84, Area T, segment of a floor in Locus 4024



Figure 85, Area T, the probe in Locus 4019, Mamluk shards, apparently wall W 1210 dates from the Mamluk period as well and the top structure.



Figure 86. Area T, Locus 4020, Mamluk pottery on the floor of the locus.



Figure 87. Area T, a stone spindle whorl from locus 4018 in square A 69



Figure 88. Area T. Locus 4019, Mamluk and Rashdiyah el Fukhar pottery



Figure 89. Area T, Locus 4022, baulk removal. Iron hand cuffs and Mamluk pottery



Figure 90. Area T, Locus 4019, a shard of pottery with fabric impression



Figure 91. Area T, Locus 4019, Mamluk pottery



Figure 92. Area T, Locus 4019, a Seleucid coin

BETHSAIDA 2015 SEASON – COIN REPORT

Dr. Gregory Jenks

Nine (9) coins were recovered during the 2015 season. While they have not yet been formally identified, a preliminary examination of the coins suggests the following analysis:

A South (no coins)

A West (2 coins)

B23714 - Ptolemaic

B23968 - Mamluk?

Area C (4 coins)

B22012 - Ayyoubid?

B22025 similar to B22030, so probably Tyrian

B22030 Tyrian

B22034 illegible, probably Seleucid

Area T (3 coins)

B31261 small blank coin, possibly Mamluk

B31262 small classical coin similar to B22030 and B22034

B31263 small silver Ottoman, probably Egypt