



9TH ANNUAL
**STUDENT RESEARCH
AND CREATIVE
ACTIVITY FAIR**

FRIDAY, MARCH 3, 2017 | 9 A.M. - 4 P.M.

The University of Nebraska at Omaha

Dr. C.C. and Mabel L. Criss Library

UNIVERSITY OF
Nebraska
Omaha



WELCOME

Thank you for your participation in the 9th Annual Student Research and Creative Activity Fair (RCAF). Research at the University of Nebraska at Omaha is on the rise. Externally funded support for research and creative activity at UNO has grown nearly 50% in the past five years. This coincides with increased student scholarship across campus and a subsequent 80% increase in student RCAF participation. We strive to provide diverse opportunities for students to become engaged in research and creative activity on campus. Those experiences will be on display throughout the day in the form of oral presentations, performances, poster presentations, and exhibits.

Student research on campus is not possible without the mentorship of dedicated faculty advisors. We thank the more than 110 advisors across all six of UNO's colleges and UNL's College of Engineering, for their time and expertise. We express special gratitude to Dean David Richards and the faculty and staff of Criss Library for hosting and supporting this event.

The awards and opportunity to present to judges is an exciting part of the event. Thank you to our judges, who are valued colleagues and friends from the community, for spending the day with us. We appreciate your support of student research and creative activity at UNO.

Sincerely,

Scott D. Snyder, Ph.D.

UNO's Chief Research Officer

TABLE OF CONTENTS

SCHEDULE AT-A-GLANCE		4
FACULTY MODERATORS		4
JUDGES		6
FACILITY MAPS		8
ORAL PRESENTATIONS/PERFORMANCES		10
POSTERS/DEMONSTRATIONS/EXHIBITS		20
INDEX OF PARTICIPANTS		36

PLEASE...

Be courteous during oral presentations in Classrooms 231, 232, 225, and 249 by:

- Muting all electronic devices, such as cell phones.
- Entering and exiting the room only between presentations when possible.
- Moving as quietly as possible if you must enter or exit the room.

SCHEDULE AT A GLANCE

9:00 - 10:15 A.M.	Poster Presentation Session 1
9:00 - 10:15 A.M.	Oral Presentation Session 1
10:15 - 10:30 A.M.	Break
10:30 A.M. - 11:45 A.M.	Oral Presentation Session 2
10:45 A.M. - 12:00 P.M.	Poster Presentation Session 2
11:30 A.M. - 1:00 P.M.	Lunch
12:30 - 1:45 P.M.	Poster Presentation Session 3
12:45 - 2:00 P.M.	Oral Presentation Session 3
1:45 - 2:15 P.M.	Break
2:15 - 3:30 P.M.	Poster Presentation Session 4
2:15 - 3:30 P.M.	Oral Presentation Session 4
3:45 - 4:15 P.M.	Awards Ceremony in the Lower Level

FACULTY MODERATORS

Abby Bjornsen	Counseling	Griff Elder	Mathematics
Heidi Blackburn	Criss Library Research Services	Ann Fruhling	Interdisciplinary Informatics
Raj Dasgupta	Computer Science	Hannah Gill	English
Paul Davis	Biology	Matt Hale	Interdisciplinary Informatics
Shari DeVeeney	Special Education & Communication Disorders	Wei Jing	Nebraska Business Development Center
Tim Dickson	Biology	P. Roxanne Kellar	Biology
Danae Dinkel	Health, Physical Education & Recreation	Alan Kolok	Biology

Anastasia Kyvelidou	Biomechanics	Adam Rosen	Health, Physical Education & Recreation
Gina Ligon	Marketing & Management	Lisa Scherer	Psychology
Guoqing Lu	Biology	Emanuel Schreiner	Psychology
Ann Luther	Counseling	Ryan Schuetzler	Information Systems & Quantitative Analysis
Kelly MacArthur	Sociology/Anthropology	Deborah Smith-Howell	Graduate Studies
Harmon Maher	Geography/Geology	Roma Subramanian	Communication
Craig Maher	Public Administration	Kota Takahashi	Biomechanics
Dora Matache	Mathematics	William Tapprich	Biology
Mukul Mukherjee	Biomechanics	Christine Toh	Interdisciplinary Informatics
John Noble	Health, Physical Education & Recreation	Daniel Wuebben	Goodrich Scholarship Program
Sachin Pawaskar	Information Systems & Quantitative Analysis	Jenna Yentes	Biomechanics
Joseph Price	College of Arts & Sciences	Haizhen Zhong	Chemistry
Patrice Proulx	Foreign Languages		
Claudia Rauter	Biology		

Thank you to our faculty moderators for their time and assistance with today's activities.

JUDGES

NAME	ORGANIZATION
Brian Allison	Children's Hospital & Medical Center
Sara Ausdemore-Matteo	First Data
Nikki Bauer	First Data
Danise M. Brownlee	HelmsBriscoe
Ben Bryan	Nebraska Applied Research Institute
Adam J. Case, Ph.D.	University of Nebraska Medical Center
Lynn Castrianno	Nebraska Families Collaborative
Barbee Davis	Davis Consulting
Vanessa Denney	University of Nebraska Foundation
Jody duRand	Omaha Public Library
Dr. Bradley Ekwerekwu	Avenue Scholars Foundation
Monique Farmer	Omaha Public Schools
Anthony Flott	University of Nebraska Foundation
Judith Gale	Creighton University
Nina Graziano	Habitat for Humanity of Omaha
Barbi Hayes	Hayes Environmental LLC
Kristina Haynie	Project Harmony
Brigid Howard	GOALS Center
Dr. David Jackson	University of Nebraska
Stancia J. Whitcomb Jenkins	University of Nebraska
Kathleen A. Johnson	University of Nebraska-Lincoln
Brandi Kerns	First Data
Leslie Kuhnel	CHI Health Ethics Services
Kathleen Lawler Hustead	Omaha Performing Arts

NAME	ORGANIZATION
Tom Lawson	Nebraska Applied Research Institute
Glenn Leatherwood	Valmont Industries
Dan Monaghan, Ph.D.	University of Nebraska Medical Center
Turner Morgan	Habitat for Humanity of Omaha
Todd Morris	PayPal
Wendy Patterson	Early Childhood Services
Andy Rikli	Papillion-LaVista School District
Jessica Schieffer	First Data
Steven J. Schreiner, Ph.D.	University of Nebraska Medical Center
Karla V. Sigala	Lewis and Clark National Historic Trail, National Park Service
Andrew Simpson	Farnham & Simpson PC LLO
Marty Skomal	Nebraska Arts Council
Nicholas Smith	Boys Town National Research Hospital
Bill Snyder	Peru State College
Chris Sommerich	Humanities Nebraska
Mark A. Spadaro	Dyna-Tech Aviation Services, Inc.
Lisa St. Clair	Omaha Program Evaluation Services
Janet Steele, Ph. D.	University of Nebraska Kearney
Emily Trotter	First Data
Dr. Paul Twigg	University of Nebraska Kearney
Stacey Warner	Region 6 Behavioral Healthcare

THANK YOU TO OUR JUDGES FOR YOUR TIME AND EXPERTISE.



CRISS LIBRARY MAIN LEVEL

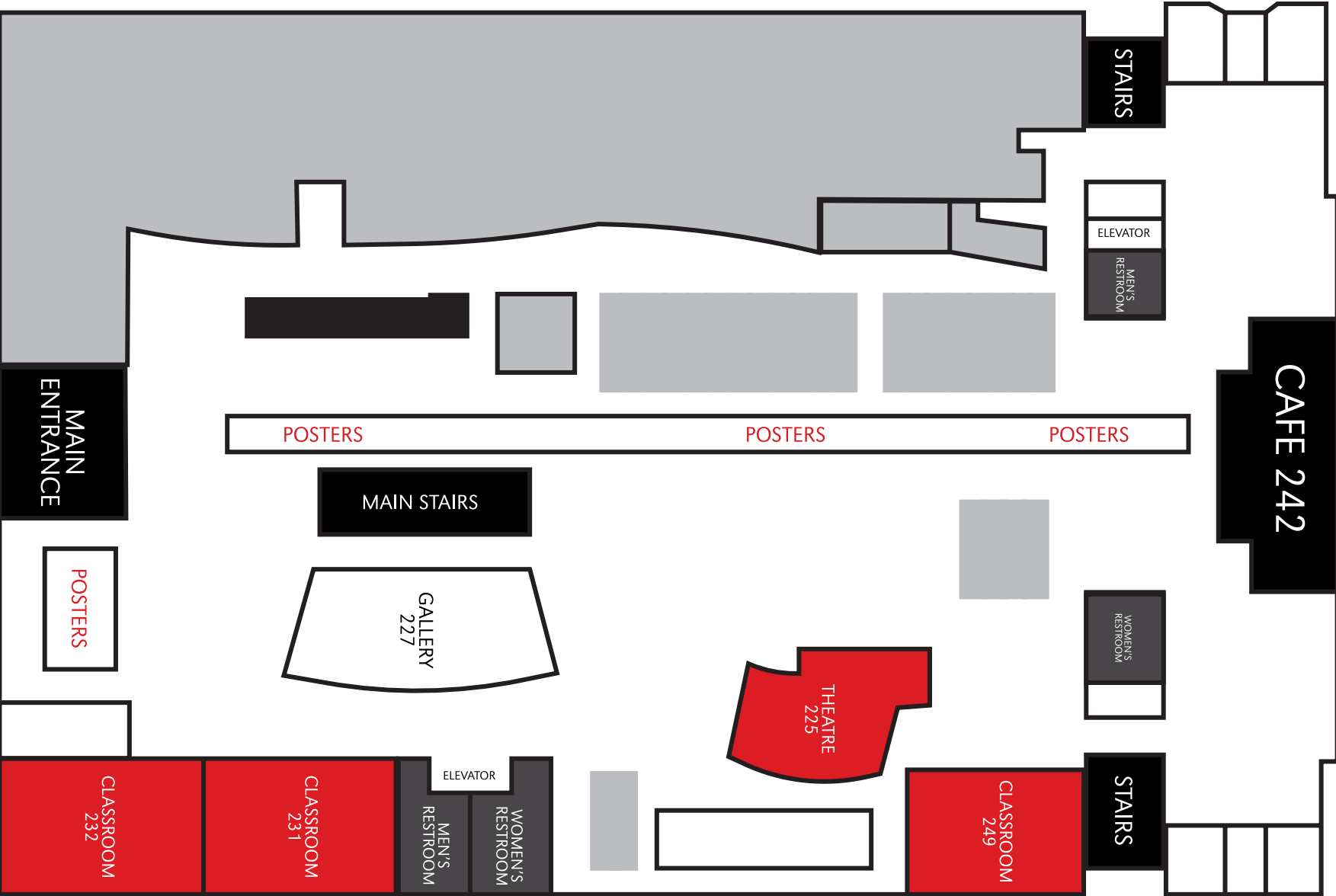

CRISS LIBRARY LOWER LEVEL

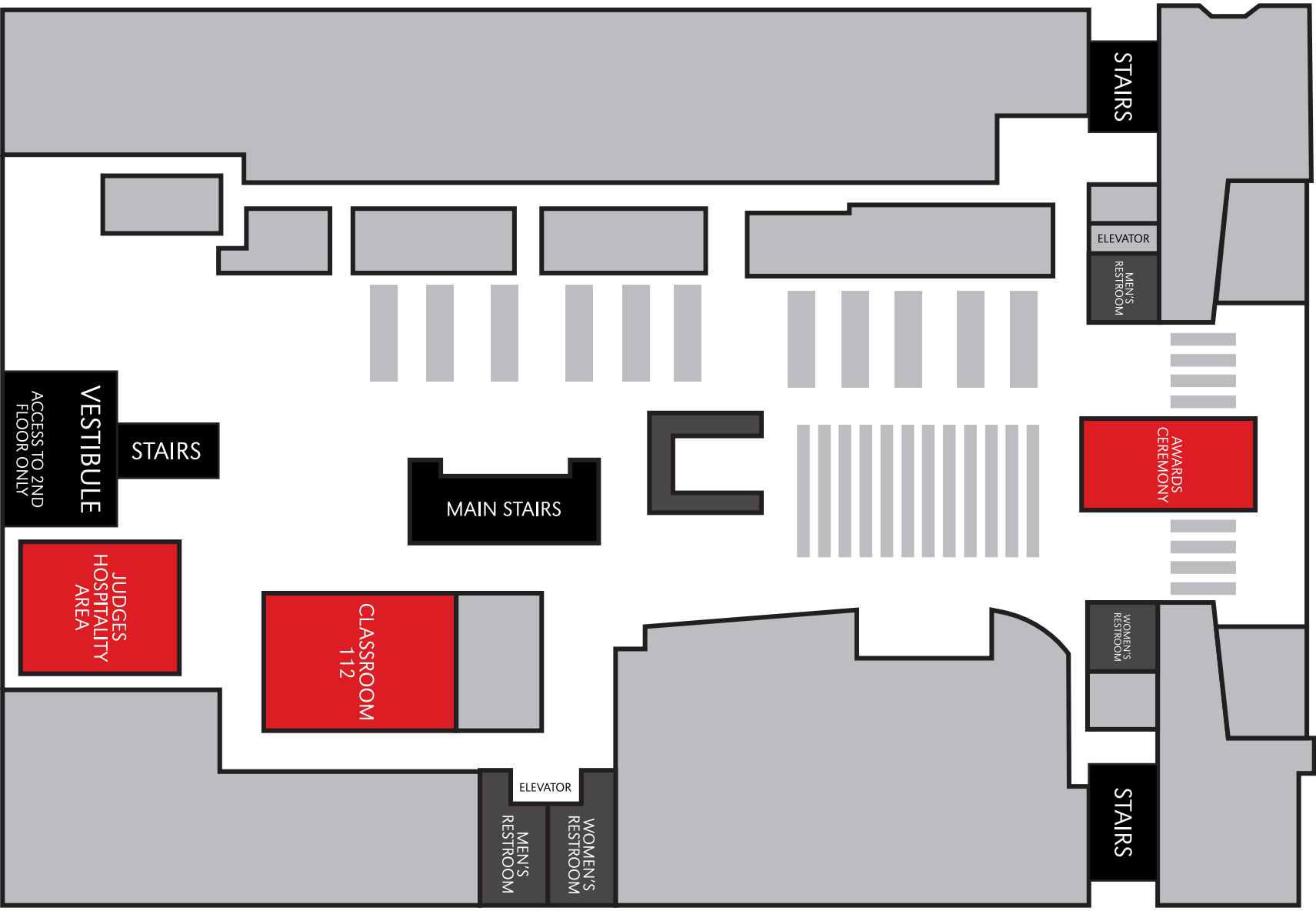

ORAL PRESENTATIONS AND PERFORMANCES

TIME	STUDENT	PROGRAM	ADVISOR	ROOM
ROOM 225				
9:00 A.M.	Joseph Devlin	UG - Bioinformatics	Kathryn Cooper	225
	Modification of the Ruiz-Moreno Chikungunya SEIR Model			
9:15 A.M.	Austin Gowen	UG - Neuroscience	Ryan Wong	225
	Regional Gene Expression Patterns in the Brain Linked to Stress Behavior in Zebrafish			
9:30 A.M.	Dallas Nelson	UG - Psychology	Lisa Scherer	225
	Traditional Versus Non-traditional College Student Employment Experiences			
9:45 A.M.	Katherine Schwartz	UG - Secondary Education	Julie Delkamiller	225
	Deaf Education and Mental Health			
10:00 A.M.	Noah Diaz	UG - Theatre	Ryan Hartigan	225
	Wild Animals You Should Know: Survival, Self Actualization, and Every Millenial's Desire to Tell the Truth			
10:15 - 10:30 A.M. BREAK				
10:30 A.M.	Jessica Wilson	UG - Mathematics - Teachers of Math	Michael Matthews	225
	Effects of Inquiry Based Learning on an Undergraduate Precalculus Course			
10:45 A.M.	Ameen Wahba	UG - Psychology	Lisa Scherer	225
	Meditation as an intervention for college students			
11:00 A.M.	Laurie Barry	UG - Religion	Curtis Hutt	225
	Women and Religion: Contemporary Readings of Ancient Texts			

TIME	STUDENT	PROGRAM	ADVISOR	ROOM
11:15 A.M.	Quinn Nelson & Donald Steffensmeier	UG - Biomedical Informatics	Hesham Ali	225
	<i>Optimizing Campus Mobility with a focus on Sustainability: A Graph Theory Approach to Intra-Campus Transportation Networks</i>			
11:30 A.M.	Mikayla Woodard	UG - Psychology	Lisa Scherer	225
	<i>Being Proactive: Ways in Which College Students Prevent Stress</i>			
11:45 A.M. - 12:45 P.M. LUNCH				
1:00 P.M.	Jon Cavanaugh	GD - Psychology	Jeffrey French	225
	<i>Marmosets' behavioral and hormonal responses to unfamiliar intruders</i>			
1:15 P.M.	Julia Fuller	GM - Criminology and Criminal Justice	Gina Ligon	225
	<i>Examining the Influence of Violent Extremist Organizations Branding on Attack Performance</i>			
1:30 P.M.	Olimpiya Saha	GD - Information Technology	Prithviraj Dasgupta	225
	<i>Real-Time Robot Path Planning Around Complex Obstacle Patterns through Learning and Transferring Options</i>			
1:45 P.M.	Austin Duncan	GM - Biomechanics	Vivien Marmelat	225
	<i>Bridging the Gap: Individual Relationships of Gait Variability and Adaptability</i>			
2:00 - 2:15 P.M. BREAK				

TIME	STUDENT	PROGRAM	ADVISOR	ROOM
2:15 P.M.	Ursula VanAntwerp	GM - Communication	Joy Chao	225
	<i>How the authentic leadership behaviors of extraverted and introverted college instructors influence students: A qualitative study</i>			
2:30 P.M.	Ammar Abid	GM - Management Information Systems	Christine Toh	225
	<i>Information Archetypes</i>			
2:45 P.M.	Chase Rock	GM - Exercise Science	Kota Takahashi	225
	<i>Efficient Variability: Linking Fractal Walking Patterns with Metabolic Energy Savings</i>			
3:00 P.M.	Michael Logan	GD - Criminology and Criminal Justice	Gina Ligon	225
	<i>Childhood Victimization Pathways and Violent Extremism</i>			

ROOM 231

9:00 A.M.	Sean West	GD - Biomedical Informatics	Hesham Ali	231
	<i>Levying the Flood of Domain Knowledge for Integration with Experimental Data in Biological Networks</i>			
9:15 A.M.	Eric Behrens	GM - Biology	Timothy Dickson	231
	<i>Small Scale Heterogeneity in Vegetation Structure in a Patch Burn Grazing Landscape</i>			
9:30 A.M.	Andrew Riquier	GD - Psychology	Suzanne Sollars	231
	<i>Microglia Response to Taste Nerve Injury Lasts Less Than Two Weeks in Young Rats</i>			
9:45 A.M.	Vidya Bommanapally, Srikanth Vadla & Shane McDermott	GM - Computer Science	Abhishek Parakh	231
	<i>An Interactive Gamified Educational Platform for Quantum Cryptography: QuaSim</i>			
10:00 A.M.	Jordan Wickstrom	GD - Biomechanics	Anastasia Kyvelidou	231
	<i>Investigating the Interaction Between Social and Motor Processes in Children with Autism</i>			

TIME	STUDENT	PROGRAM	ADVISOR	ROOM
10:15 - 10:30 A.M. BREAK				
10:30 A.M.	Mithra Pirooz	GM - Psychology	Jonathan Santo	231
	Predictors of General Self-Worth Among Early Adolescents: Support, Competence, and Self-Construal			
10:45 A.M.	Emily Pachunka	GM - Biomedical Informatics	Kathryn Cooper	231
	Gateway Node Analysis of Gene Expression in the Diauxic Shift of Saccharomyces cerevisiae			
11:00 A.M.	Saul Knoblauch	GM - English	David Peterson	231
	Bloody Drops: Walt Whitman, Dracula, and Sexuality			
11:15 A.M.	Kevin Mitchell	GM - Industrial/ Organizational Psychology	Roni Reiter-Palmon	231
	Unpacking divergent thinking and intelligence: How factors influence creative performance			
11:30 A.M.	Ayan Dutta	GD - Computer Science	Prithviraj Dasgupta	231
	Locomotion Learning in Modular Self-Reconfigurable Robots			
11:45 A.M. - 12:45 P.M. LUNCH				
12:45 P.M.	Thomas Seguin	GM - Counseling	Abby Bjornsen	231
	A wellness approach to investigating student veterans academic and career goals			
1:00 P.M.	Yara Mahfood Haddad	GM - Computer Science	Hesham Ali	231
	Managing Self-Organized IoT Networks Using Multi-Stage Graph Approaches			
1:15 P.M.	Samuel Ray	GM - Exercise Science	Kota Takahashi	231
	Augmenting Human Muscle Performance through Added Foot Stiffness			
1:30 P.M.	Venkat Ramana Reddy Garlapati	GM - Computer Science	Prithviraj Dasgupta	231
	Autonomous UAV Navigation in an Indoor Environment for Warehouse Inventory Recording			

TIME	STUDENT	PROGRAM	ADVISOR	ROOM
1:45 P.M.	Jeremy Gutierrez	GM - History	Kent Blansett	231

Acceptance or Resistance: The Effect Western Tourism has on Performance of Indigenous populations of the South Pacific

2:00 - 2:15 P.M. BREAK

2:15 P.M.	Elham Rastegari	GD - Biomedical Informatics	Hesham Ali	231
-----------	------------------------	-----------------------------	------------	-----

On the Analysis of Treatment Options Using Social Networks

2:30 P.M.	Sharon Genoways	GD - Educational Leadership	Neal Grandgenett	231
-----------	------------------------	-----------------------------	------------------	-----

The Experiences of Female High School Students and Interest in STEM: What Factors Lead to the Selection of an Engineering or Computer Science Major

2:45 P.M.	Bradon Valgardson	GD - Criminology and Criminal Justice	Joseph Schwartz	231
-----------	--------------------------	---------------------------------------	-----------------	-----

An Examination of Within and Between Family Influences on the Intergenerational Transmission of Violence and Maltreatment

3:00 P.M.	Chase Wickard	GM - Biology	John McCarty	231
-----------	----------------------	--------------	--------------	-----

*Landscape Effects on Brown-headed Cowbird (*Molothrus ater*) Abundances in CRP Patches*

ROOM 232

9:00 A.M.	Matthew Martens	UG - Bioinformatics	Paul Davis	232
-----------	------------------------	---------------------	------------	-----

*The Evaluation of Carbon Dioxide-Independent Media for *Toxoplasma gondii* Growth*

9:15 A.M.	Hilary Jenkins	UG - Psychology	Lisa Scherer	232
-----------	-----------------------	-----------------	--------------	-----

The Challenges of College: How Students Cope with Stress

9:30 A.M.	Harim Won	UG - Biotechnology	Paul Davis	232
-----------	------------------	--------------------	------------	-----

*Binding of a Hypothetical Transcription Factor Drives Stage Conversion in *Toxoplasma gondii**

9:45 A.M.	Patrick Dunlap	UG - Social Work	Amy West	232
-----------	-----------------------	------------------	----------	-----

Understanding Queer/Trans Identity and Faith: An Intersectional Approach

TIME	STUDENT	PROGRAM	ADVISOR	ROOM
10:00 A.M.	Grace Kolbo, Roni Shelley Perez, Elijah Brown & Marcel Daly	UG - Music	Shelby VanNordstrand	232

National Opera Association National Convention - Opera Scenes Competition

10:15 - 10:30 A.M. BREAK

10:30 A.M.	Grogan Huff	UG - Bioinformatics	Kathryn Cooper	232
------------	--------------------	---------------------	----------------	-----

Correlation Networks: Causative Relationships from Gene Expression Data

10:45 A.M.	Jacob Robinson	UG - Chemistry	Christine Cutucache	232
------------	-----------------------	----------------	---------------------	-----

Characterization of a role for Cav1 in the development of the immune response

11:00 A.M.	Heather Rozema	UG - Philosophy	Laura Grams	232
------------	-----------------------	-----------------	-------------	-----

Connection between Neural Chemistry Personality Formation and Normative Ethic Choice

11:15 A.M.	Sandra Vargas-Salinas	UG - Psychology	Lisa Scherer	232
------------	------------------------------	-----------------	--------------	-----

Extra-Curricular and Volunteering: How Good Are They?

11:30 A.M.	Abi Heller	UG - Neuroscience	Janelle Beadle	232
------------	-------------------	-------------------	----------------	-----

Brain Networks Related to Loneliness in Adolescents

11:45 - 12:45 P.M. LUNCH

12:45 P.M.	Benjamin Hayworth	UG - Philosophy	Andrew Newman	232
------------	--------------------------	-----------------	---------------	-----

The Property of Mass: An Interdisciplinary Metaphysical Investigation

1:00 P.M.	Casey Caniglia	UG - Exercise Science	Jenna Yentes	232
-----------	-----------------------	-----------------------	--------------	-----

Creating a standard in at-home pulmonary exercise maintenance program: A pilot study

1:15 P.M.	Margaret Moore	UG - Biology	Paul Davis	232
-----------	-----------------------	--------------	------------	-----

*The Effect of Various Mixed Medias on *Toxoplasma gondii* Cyst Growth*

TIME	STUDENT	PROGRAM	ADVISOR	ROOM
1:30 P.M.	Roland Buchta	UG - Foreign Language and Literature	Patrice Proulx	232
	<i>Twenty First Century Representations of Albert Camus's L'Hôte</i>			
1:45 P.M.	Stephanie Hines	UG - Psychology	Lisa Scherer	232
	<i>Fitting In?: The Role of College Experiences on Student Happiness</i>			

2:00 - 2:15 P.M. BREAK

2:15 P.M.	Britny Doane	UG - Religion	Michele Desmarais	232
	<i>Methods and Madness Poetry that explores the religious phenomena of Divine Inspiration</i>			
2:30 P.M.	Lily DeFrank	UG - Social Work	Amy West	232
	<i>Addressing Cultural Humility and Diversity Education Within Social Work</i>			
2:45 P.M.	Hanna Miller	UG - Communication Studies	Paige Toller	232
	<i>Why Follow? Followership Favorability and Followership Styles</i>			
3:00 P.M.	Gabrielle Gergen	UG - Psychology	Lisa Scherer	232
	<i>Do Part-Time Employers Hurt or Help Working College Students' Success?</i>			
3:15 P.M.	Maggie Edwards	UG - Psychology	Lisa Scherer	232
	<i>Relationship Experiences and Quality on College Student Stress and Well-Being</i>			

ROOM 249

9:00 A.M.	Brad Woosley	GD - Information Technology	Prithviraj Dasgupta	249
	<i>Multi-Robot Informed Path Planning under Communication Constraints</i>			
9:15 A.M.	Jacquelyn Davis	GD - Psychology	Suzanne Sollars	249
	<i>Sharing Your Science: Creating an Educational Outreach Program</i>			

TIME	STUDENT	PROGRAM	ADVISOR	ROOM
9:30 A.M.	Madalyn McFarland	GM - Biology	Paul Davis	249
	<i>Investigation of mechanism of resistance in early lead anti-Toxoplasma compounds</i>			
9:45 A.M.	Alicia Buttner	GD - Psychology	Rosemary Strasser	249
	<i>Social buffering of the stress response in dogs from diverse backgrounds</i>			
10:00 A.M.	Doug Meigs	GM - Sociology	Beth Ritter	249
	<i>Lone Man and All My Relations</i>			

10:15 - 10:30 A.M. BREAK

10:30 A.M.	Erica Nightengale	GM - Music Performance	Christine Beard	249
	<i>Contemporary Flute Music by Argentine Composers</i>			
10:45 A.M.	Lindsay Brown	GM - Biology	LaReesa Wolfenbarger	249
	<i>Landscape features that influence the habitat use of migratory shorebirds in agriculture fields in the Rainwater Basin, Nebraska</i>			
11:00 A.M.	Troy Rand	GD - Exercise Science	Mukul Mukherjee	249
	<i>Temporal correlations of support surface movement affect the control of center of pressure velocity</i>			
11:15 A.M.	Mohan Sai Ambati	GM - Computer Science	Jose Baca Garcia	249
	<i>A Modular Robotic System for Assessment and Exercise of Human Movement</i>			
11:30 A.M.	Emily Geest	GM - Biology	John McCarty	249
	<i>Recruitment, survival, and parasitism of monarchs in residential gardens and conservation areas</i>			

11:45 - 12:45 P.M. LUNCH

12:45 P.M.	Nicole Damen	GM - Management Information Systems	Christine Toh	249
	<i>Pilot Study: Understanding the Role of Agent Gender and Location on User Perceptions of Trust in Home Automation</i>			

TIME	STUDENT	PROGRAM	ADVISOR	ROOM
1:00 P.M.	Jenny Kent	GD - Exercise Science	Nicholas Stergiou	249
	The Stochastic Resonance paradigm – A means to restore sensation and function after lower limb loss?			
1:15 P.M.	Michelle Huffman	GD - Psychology	Jeffrey French	249
	Neuroendocrine and psychological variables associated with burnout and compassion fatigue in mental health professionals			
1:30 P.M.	Elham Rastegari	GD - Biomedical Informatics	Hesham Ali	249
	On Big Data Approach for Utilizing Mobility Features to Assess Health Levels			
1:45 P.M.	Ryan Galer	GM - Economics	Catherine Co	249
	How High Will America Go? An Analysis of Youth Marijuana Use Rates due to Legalization of Medical Marijuana Use			
2:00 - 2:15 P.M. BREAK				
2:15 P.M.	Joshua Hoxmeier	GM - History	Danielle Battisti	249
	An Oral History of Italian American Identity & Perception During the First Half of the 20th Century			
2:30 P.M.	Sungho Park	GD - Public Administration	Craig Maher	249
	Game-theoretic Thinking of State-imposed Tax and Expenditure Limitations (TEs): Rule Design, Institutional Diversity, and Municipal Fiscal Outcomes			
2:45 P.M.	Suyeon Kim	GM - Biomedical Informatics	Hesham Ali	249
	A systems biology approach to analyze microbiome in soil and fish guts			
3:00 P.M.	Colleen Rothe-Groleau	GM - Biology	James Fawcett	249
	Natural History and Reproductive Biology of a Population of Prairie Rattlesnakes from Kansas			



POSTERS/DEMONSTRATIONS/EXHIBITS

225

#	STUDENT	PROGRAM	ADVISOR
SESSION 1: 9:00 - 10:15 A.M.			
201	Joseph Mroz & Nicole Landowski	GM - Psychology	Joseph Allen
	<i>Why Arriving Late to Meetings May Harm Workplace Relationships</i>		
203	Brandon Bischoff	UG - Exercise Science	Vivien Marmelat
	<i>Stitching Together Short Gait Trials for Understanding Stride-to-Stride Organization Over Time</i>		
205	Natalie Scarpa & Tova Hettinger	GM - Public Administration/ Social Work	Jeanette Harder
	<i>Visualizing a Complex Evaluation: A Tuition Stipend Program for Child Welfare Workers</i>		
207	Drew Dudley	GM - Exercise Science	Jorge Zuniga
	<i>Increases in Rom and Circumference of the Forearm After 6 Months of Using a 3d Printed Transitional Hand Prosthesis</i>		
209	Sara Smith	UG - Biotechnology	Mark Schoenbeck
	<i>NCUR 2016</i>		
211	Sheridan Trent	GM - Industrial/ Organizational Psychology	Joseph Allen
	<i>Volunteer Attrition: Reducing Incivility among Coworkers</i>		
213	Christopher Johnson	UG - Biotechnology	Donald Rowen
	<i>Determining the Mechanism of Action of the Antimicrobial Peptide DASamP2 by Characterization of Resistant Mutants</i>		
215	Nikolaos Papachatzis	GM - Biomechanics	Kota Takahashi
	<i>Foot Mechanics During Walking With Added Mass</i>		

#	STUDENT	PROGRAM	ADVISOR
217	Doug Stahlnecker & Sydney Lintner	UG - Management Information Systems	Ann Fruhling
	<i>Enhancing the Citizen Scientist Experience Through Responsive Web Design</i>		
219	Michael Yoerger	GD - Psychology	Joseph Allen
	<i>Influence of Meeting Humor Styles on Meeting Satisfaction</i>		
302	Trevor Krzyzanowski	UG - Exercise Science	Dustin Slivka
	<i>Effects of Whole Body Heating During Warm-up on Strength, Power, and Flexibility</i>		
304	Haley Shelton	GM - Business Administration	Gina Ligon
	<i>Using Oculometrics for Cognitive Task Analysis</i>		
306	Michaela Marian	GM - Psychology	Suzanne Sollars
	<i>Microglia Response in the Brainstem following Lingual Nerve Injury in Rats</i>		
308	Alli Kalina	UG - Biomechanics	Sara Myers
	<i>The Effects of Walking Speed On Gait Propulsion When Wearing an Ankle-Foot Orthosis</i>		
310	James Pierce	GM - Exercise Science	Jorge Zuniga
	<i>Development of Low Cost 3D Printed Transitional Prostheses</i>		
312	Abigail Folberg	GM - Psychology	Carey Ryan
	<i>Aware of what? The structure and meaning of gender aware and blind ideologies across gender and race</i>		
314	Mahmud Bezhani	UG - Chemistry	William Tapprich
	<i>SHAPE Analysis of 5 Untranslated Region of CVB3-28 genomic RNA</i>		

#	STUDENT	PROGRAM	ADVISOR
316	Alejandro Bustillos	GM - Theatre	Cynthia Phaneuf
	<i>Contemporary Ethnographic Performance Methodologies in London</i>		
318	Shane Warehime	GD - Exercise Science	Danae Dinkel
	<i>Postpartum Mothers Physical Activity & Sleep: A Comparison of Overweight/Obese and Normal Weight Mothers</i>		
320	Amy Proskovec	GM - Psychology	Tony Wilson
	<i>Beta Oscillatory Dynamics are Modulated by Load during a Spatial Working Memory Task</i>		
501	Molly Sullivan	GM - Industrial/ Organizational Psychology	Carey Ryan
	<i>The Role of Communal Goal Orientation in Workplace Preferences</i>		
502	James Stanton	UG - Neuroscience	Bruce Chase
	<i>Levdodopa-Induced Motor Behavior Alterations in Drosophila Larvae</i>		
503	Shawn Daley	GM - Health, Physical Education & Recreation	Vivien Marmelat
	<i>The Effect of Happy vs. Sad Music on Gait Variability</i>		
504	Jessica Rerucha	UG - Environmental Science	Claudia Rauter
	<i>Social Immunity in a Sub-social Insect: Influence of Parental Care and Exposure to Microbes During Development</i>		
505	Sidney Baudendistel	GM - Exercise Science	Jenna Yentes
	<i>An Investigation in Muscle Activation During Load Carrying</i>		
506	Erin Nyquist & Rebekka Erks	GM - Industrial/ Organizational Psychology	Joseph Allen
	<i>Wait, the boss is coming?! Put on your happy face!: Emotional labor in meetings</i>		
507	Ryan Hartley	UG - Biomechanics	Vivien Marmelat
	<i>Comparison of Self-Paced, Fixed Speed, and Overground Walking</i>		
508	KayLee Taylor	UG - Theatre	Valerie St. Pierre Smith
	<i>The Applications of 3D Printing Technology in Jewelry Making for Costuming</i>		

#	STUDENT	PROGRAM	ADVISOR
509	Kelly Prange	GM - Psychology	Joseph Allen
	<i>Volunteer Perceptions of Upward and Downward Communication Facilitate Organizational Commitment</i>		
510	Maeghan Fry	UG - Computer Science	Yuliya Lierler
	<i>Knowledge-Based Linguistic Reasoning in Winograd-Schema Challenge</i>		
511	Morgan Busboom	GM - Health, Physical Education & Recreation	Dustin Slivka
	<i>Responses of Appetite and Appetite Regulating Hormones to Acute Altitude Exposure</i>		
512	Clare Maakestad	GM - Sociology	Julie Pelton
	<i>Harvesting the City: Sustainability, Sustenance, and Community Gardens in Omaha, Nebraska</i>		
513	Samuel Maaiah	UG - Biotechnology	Kota Takahashi
	<i>The effect of auditory stimulation on human movement variability and associated cortical involvement</i>		
514	Robert Shute	GD - Exercise Science	Dustin Slivka
	<i>Effects of Hypobaric and Normobaric Hypoxia on Mitochondrial Related Gene Expression</i>		
515	Marvin Sibrian	UG - Environmental Science	Timothy Dickson
	<i>Establishment of Milkweed Seeds Under Different Conditions</i>		
516	Kristi Apa	GM - Psychology	Suzanne Sollars
	<i>Foliate Taste Bud Volume Following Chorda Tympani Nerve Injury in Rats</i>		
517	Monica Blaser	UG - Environmental Science	Alan Kolok
	<i>A longitudinal study utilizing citizen science to assess the presence of atrazine within the Mississippi River watershed</i>		
518	Nicholas Than	GM - Exercise Science	Jorge Zuniga
	<i>Upper-limb prosthetics</i>		
519	Connor Wicks	UG - Physics	Vivien Marmelat
	<i>Between-day reliability of daily activity fluctuations in young adults at baseline and 6-months follow-up</i>		

#	STUDENT	PROGRAM	ADVISOR
SESSION 2: 10:45 A.M. - 12:00 P.M.			
202	Taylor Leeder	GM - Exercise Science	Julie Boron
	<i>Effects of Serial Subtraction on Elderly Gait Speed in a Virtual Reality Setting</i>		
204	Danielle Rutz	GM - Industrial/ Organizational Psychology	Carey Ryan
	<i>Cynical towards What? Cynicism towards Management and Cynicism towards Diversity Training Differentially Relate to Post-Diversity-Training Measures</i>		
206	Brian Felderman	UG - Computer Engineering	Dongming Peng
	<i>AES on FPGAs: Implementation and Performance Trade-offs</i>		
208	Thomas Schulze & Austin Sanford	GM - Biology	Paul Davis
	<i>The Efficacy of KG Series Derivatives for the Treatment of Toxoplasmosis</i>		
210	Naresh Pasupuleti	GM - Management Information Systems	Kathryn Cooper
	<i>A Network model to investigate robustness of gene expressions</i>		
212	Alyssa Averhoff	UG - Biotechnology	Anastasia Kyvelidou
	<i>Infants at High-Risk for ASD Exhibit Greater Fixation Durations than Infants at Low-Risk</i>		
214	Lydia Perkins & Laura Dilley	UG - Psychology	Carey Ryan
	<i>Gender differences in STEM workplace: reports of incivility</i>		
216	Srikanth Vadla, Shane McDermott & Vidya Bommanapally	GM - Information Assurance	Abhishek Parakh
	<i>QuaSim: A Virtual Educator for Quantum Cryptography</i>		
218	Kelly Prange	GM - Psychology	Joseph Allen
	<i>The Effect of Leader Behavior on After-Action Review Outcomes</i>		
220	Bashayer Hammadi	UG - Speech-Language Pathology	Lucy Morrison
	<i>Gooseberries and Christensens wives</i>		

#	STUDENT	PROGRAM	ADVISOR
301	Nishchala Tangirala	UG - Computer Science	Sanjukta Bhowmick
	<i>Modeling and Influencing Epidemic Spread in Large Networks</i>		
303	Abigail Folberg	GM - Psychology	Carey Ryan
	<i>Not so traditional after all: The role of traditionalism in workplace choices among Jewish and Arab Israeli women</i>		
305	Christopher Dziatkowski	UG - International Studies	Jill Blankenship
	<i>Generation of a fluorogen-activating tag for Candida albicans protein localization</i>		
307	Natividad Hernandez	GM - Health, Physical Education & Recreation	Jason Coleman
	<i>Engagement of Latino/Hispanic MSM in HIV prevention</i>		
309	Elyssa Monzingo	UG - Biotechnology	Paul Davis
	<i>Effects of Antischistosomal Compounds on Immune Response</i>		
311	Rebecca Cuthbert	GM - Exercise Science	Dustin Slivka
	<i>Human Stress Protein Response to Exercise and the Environment</i>		
313	Nicole Landowski	GD - Industrial/ Organizational Psychology	Joseph Allen
	<i>The Meeting Went Great! Or Did It? Identifying the Meeting Leader Blindspot</i>		
315	Hannah Bergwell	UG - Neuroscience	Suzanne Sollars
	<i>Chronic Oral Administration of Capsaicin Does Not Induce a Microglia Immune Response</i>		
317	Eagan Behne	UG - Chemistry	Haizhen Zhong
	<i>Structural impact of Cytochrome P450 CYP2D6 mutant variants on drug metabolism: a computational study</i>		
319	Zachary Motz	GD - Biomechanics	Anastasia Kyvelidou
	<i>Healthy young children can intentionally couple postural sway with stimuli of differing complexity</i>		

#	STUDENT	PROGRAM	ADVISOR
601	Molly Schieber	GM - Exercise Science	Sara Myers
	<i>Muscle Strength and Motor Control Characteristics at the Ankle are Altered in Peripheral Artery Disease</i>		
602	Ji Seul Kim	GD - Public Administration/ Social Work	Carol Ebdon
	<i>Allocative effects of state capital budgeting institutions</i>		
603	Grace Brown	UG - Chemistry	Alan Gift
	<i>Beginning to Understand Pharmaceutical Transformations: Investigating Nitrofurantoin</i>		
604	Shane Lentz	UG - Exercise Science	Sara Myers
	<i>Treadmill Walking in Claudication</i>		
605	Stephanie Hengen	GM - Psychology	Adam Weaver
	<i>Accommodations at UNO; What You Don't See</i>		
606	Sofia Rahmanzai	UG - Biotechnology	Paul Davis
	<i>Effects of Early Transition from Intravenous to Oral Antimicrobial Treatment in Pediatric Osteomyelitis</i>		
607	Michelle Tully	GM - Psychology	Wayne Harrison
	<i>School's (not) out: Effects of perceived safety for sexual minorities and school climate on school involvement</i>		
608	Bryon Applequist	GD - Biomechanics	Anastasia Kyvelidou
	<i>Recurrence Quantification Analysis of Gait Coordination in Children: With and Without Footwear</i>		
609	Henamari Ybay & Miche Okura	UG - Biology	Sara Myers
	<i>Range of Motion and Walking Distances in Subjects with Peripheral Artery Disease</i>		
610	Nicholas Reynolds	GM - Exercise Science	Vivien Marmelat
	<i>Influence of neuromuscular fatigue on the reliability of gait variability measures</i>		
611	Mark Carter	UG - Neuroscience	Suzanne Sollars
	<i>Examination of Taste Bud Volumes on the Side of the Tongue Opposite to Nerve Injury in Young and Adult Rats</i>		

#	STUDENT	PROGRAM	ADVISOR
612	Qianran Li	GM - Biomedical Informatics	Kathryn Cooper
	<i>Build the range of normalization information of gene expression correlation network in different tissues</i>		
613	Kaitlin Goettsch	UG - Bioinformatics	Haizhen Zhong
	<i>Docking Studies of Isoform-Selectivity of Phosphatidylinositol 3-Kinases (PI3Ks) Inhibitors</i>		
614	Kailey Snyder	GD - Exercise Science	Danae Dinkel
	<i>A Phenomenological Examination of the Relationship between Exercise Motivation and Weight Stigma Utilizing a Multi-Design Methodology</i>		
615	Lauren Wehrle	UG - Elementary Education	Anastasia Kyvelidou
	<i>Relationship between Cognitive Level and Sitting Posture in Infants at low and high risk for ASD</i>		
616	Amelia Lanier	PDF - Biomechanics	Nicholas Stergiou
	<i>ACL reconstruction results in alterations to force control variability during visual feedback of multidirectional for production</i>		
617	Esther Kapinga	UG - Biotechnology	Mark Schoenbeck
	<i>Development of Molecular Tools for identification of Prairie terrestrial and wetland algae</i>		
618	Rebekka Erks	GM - Psychology	Joseph Allen
	<i>Volunteers volunteer to become engaged at work</i>		
619	Christina Angeli	GM - Health, Physical Education & Recreation	Dustin Slivka
	<i>Oxygen transport in normobaric versus hypobaric hypoxia</i>		
620	Jenna Christiansen	UG - Biotechnology	Jill Blankenship
	<i>Construction of Auxotrophic Strains of Candida albicans Clinical Strains</i>		
621	Aaron Young	GM - Biology	LaReesa Wolfenbarger
	<i>Post-fledgling survival and habitat selection of Henslow's Sparrow</i>		

LUNCH

#	STUDENT	PROGRAM	ADVISOR
SESSION 3: 12:30 - 1:45 P.M.			
101	Tyler Patterson	GM - Health, Physical Education & Recreation	Danae Dinkel
	<i>A Needs Assessment of Omaha Service Providers to Better Understand Maternal Well-Being</i>		
103	Li-Dunn Chen & Alicia Buttner	UG - Psychology	Rosemary Strasser
	<i>Variables that Influence Hormonal Synchronization Between Humans and Dogs</i>		
105	Madeleine Moore	GM - Counseling	Abby Bjornsen
	<i>Counseling Resilience: The Clinical Implications of Trauma Work with Female Adolescents</i>		
107	John Hare	UG - Computer Science	Jose Baca Garcia
	<i>Passive Chemical Detection System for UAVs</i>		
109	Louis Martin	GD - Psychology	Suzanne Sollars
	<i>Substantial nerve fiber loss in the rat brainstem following early section of the chorda tympani taste nerve</i>		
111	Zechariah Craig	UG - Chemistry	Jodi Kreiling
	<i>Characterization of the Mannose-6-phosphate/Insulin-like Growth Factor II Receptor using 1-3 Myc-His</i>		
113	Srinivasa Keerthy Vishnubhotla	GM - Business Administration/Management Information Systems	Dhundy Bastola
	<i>Molecular Identification of Pathogenic Organism (MIPO)-engaging a crowd to build knowledge base</i>		
115	Jessia Bargstadt	UG - Neuroscience	Ryan Wong
	<i>The effect of observing aggressive interactions on the personality traits of Danio rerio</i>		
117	Zhiyuan Chen	GM - Computer Science	Myoungkyu Song
	<i>Tool Support for Managing Clone Refactorings to Facilitate Code Review in Evolving Software</i>		
119	Brooks Coleman	GM - Exercise Science	Dustin Slivka
	<i>The effects of hypobaric and normobaric hypoxia on heart rate and blood oxygen saturation</i>		

#	STUDENT	PROGRAM	ADVISOR
202	Connor Reed	UG - Biomechanics	Brian Knarr
	<i>Impact of Real World Environments on Movement Variability</i>		
204	Aditya Chouhan	GM - Management Information Systems	Ann Fruhling
	<i>Best practices using usability heuristic to design PHR</i>		
206	James Nielsen	UG - Exercise Science	Mukul Mukherjee
	<i>The effect of a passive exoskeletal device on locomotor adaptive ability in healthy human subjects</i>		
208	Lucas Dolezal	UG - Architectural Engineering	Ece Erdogmus
	<i>Development of Structural Design Guidelines for Compressed Stabilized Earth Block Masonry</i>		
210	Kasey Klatt	GM - Industrial/Organizational Psychology	Roni Reiter-Palmon
	<i>Intrinsic motivation and creativity: The mediating role of creative self-efficacy</i>		
212	Abhishek Tripathi	GD - Information Technology	Deepak Khazanchi
	<i>Myth or Reality? Crowdsourcing as a Complex Problem Solving Model: Evidence from Software Developed by the Crowd and Professionals</i>		
214	Kathleen Stibbs	UG - Psychology	Joseph Allen
	<i>Keep Calm and Meeting On: Meeting Professionalism and Stress</i>		
216	Kelly Helmer	UG - Geology	Harmon Maher
	<i>Analysis of Deformation Bands at Slim Buttes, South Dakota</i>		
218	Jayson Henrickson	GM - Exercise Science	Adam Rosen
	<i>The Relationship Between Center of Pressure and Body Mass Index in Individuals with Chronic Ankle Instability</i>		
220	James Hopkins	UG - Management Information Systems	Ann Fruhling
	<i>Juvenile Case Management System</i>		

#	STUDENT	PROGRAM	ADVISOR
701	Shane McDermott, Srikanth Vadla & Vidya Bommanapally	UG - Computer Science	Abhishek Parakh
	<i>QuaSim: A Quantum Cryptography Game</i>		
702	Angel Gonzalez	UG - Exercise Science	Kota Takahashi
	<i>Software-Based Teaching of Biomechanics to Engage Undergraduate Students</i>		
703	Robert Barber	GM - Exercise Science	Jenna Yentes
	<i>Comparison of Balance Between a Smoker and a Never-Smoker</i>		
704	Abderrahman Ouattas	GM - Health, Physical Education & Recreation	Brian Knarr
	<i>Peak Vertical Ground Reaction force & Stance Phase time to assess post-TKA interlimb asymmetry</i>		
705	Kristen Cunningham	GM - Psychology	Rosemary Strasser
	<i>Shared Hormonal States between Humans and Dogs at Agility Competitions</i>		
706	Jessica Fujan-Hansen	GD - Biomechanics	Mukul Mukherjee
	<i>Asymmetry in the complexity of gait in younger stroke populations: A Preliminary Study</i>		
707	Abi Heller	UG - Neuroscience	Janelle Beadle
	<i>Effects of Gender on Empathy and Prosocial Behavior</i>		
708	Joshua Irvin	UG - Computer Science	Yuliya Lierler
	<i>Rewriting Techniques to Improve Performance in Answer Set Programming</i>		
709	Sarah Carp	GM - Psychology	Jeffrey French
	<i>Partner Preference and Dopaminergic Regulation of Pair Behavior in Marmoset Monkeys</i>		
710	Reo Newring	GM - Psychology	Roni Reiter- Palmon
	<i>The influence of humorous priming and situation type on generation of malevolently creative ideas</i>		
711	Sarah Baker	GM - Exercise Science	Sara Myers
	<i>Gait biomechanics in patients with peripheral artery disease after revascularization</i>		

#	STUDENT	PROGRAM	ADVISOR
712	Cori Borgheiinck	GM - Biology	James Fawcett
	<i>Species Diversity and Relative Abundance of Herpetofauna at Glacier Creek Preserve</i>		
713	Timothy Joe	UG - Construction Management	Jose Baca Garcia
	<i>Vision-Based Mobile Robotic Platform for Autonomous Landing of Quadcopters</i>		
714	Joseph Smolsky	UG - Physics	Alexey Krasnoslobodtsev
	<i>Improving SERS-based readout strategy for biomarker detecting immunoassays</i>		
715	Ellyn Bass	GD - Psychology	Jeffrey French
	<i>Heterogeneity of Social Rejection Experiences: Further Investigation of Emotional, Physiological, and Behavioral Responses</i>		
716	Nicky Dalbir	GM - Criminology & Criminal Justice	Emily Wright
	<i>Mental Health, Substance Use, and Co-Occurring Disorders among Jail Inmates: Prevalence, Impact on Recidivism, and Gender Differences</i>		
717	Jose Davila	UG - Neuroscience	Ryan Wong
	<i>Differences in Molecular Aspects of Learning and Stress Coping Styles in Zebrafish</i>		
718	Anjani Devi Danthuluri	GM - Business Administration/Management Information Systems	Erin Bass
	<i>A Typology of Criteria used by Microfinance Institutions to Evaluate Potential Microentrepreneurs</i>		
719	Taylor Gehringer	GD - Psychology	Carey Ryan
	<i>Person-Thing Orientation: Evidence for Measurement Equivalence and Construct Validity among Israeli Students</i>		
720	Katlyn Nimtzt	GM - Health, Physical Education & Recreation	Brian Knarr
	<i>Non-linear analysis of vector magnitude and step count from activity monitor data</i>		
721	Goodmond Danielsen	UG - Biology	P. Roxanne Kellar
	<i>Taxonomic Placement of the Nidulariaceae of Nebraska and Iowa Based on Molecular and Morphological Data</i>		

#	STUDENT	PROGRAM	ADVISOR
SESSION 4: 2:15 - 3:30 P.M.			
102	Stephanie Womack	GM - Biology	Jeffrey French
	<i>Influence of neuropeptides on the salience of olfactory stimuli in marmosets</i>		
104	Zachary Meade	UG - Electrical Engineering	Kota Takahashi
	<i>Validation of Postural Sway Measurements of the Wii</i>		
106	Trevor Pentzien	UG - Mathematics	Dora Matache
	<i>Properties of Cellular Networks and Determinative Power of Nodes</i>		
108	Veronica Wolf	GM - Counseling	David Carter
	<i>Motivation and Bipolar Disorder</i>		
110	Devin Christensen	UG - Environmental Science	James Wilson
	<i>Microflora in the cheek pouches of Ord's kangaroo rat (<i>Dipodomys ordii</i>) from the Nebraska Sandhills</i>		
112	Matthew Baker & Alexander Goodman	GM - Biology	Ryan Wong
	<i>Comparing consistency of stress and anxiety-related behaviors across time in zebrafish (<i>Danio rerio</i>)</i>		
114	Jacalyn Russ	GM - Biology	Ryan Wong
	<i>Differences in behavioral responses to stress in zebrafish: exploring underlying mechanisms</i>		
116	Samuel Anderson	UG - Chemistry	James Hagen
	<i>Synthesis of Small Molecule Anti-Trypanosomal Drugs: A Brief SAR Study</i>		
118	Candi Senior-Remsa	GM - Biology	Bruce Chase
	<i>Functional Genetics of MIND-MELD in <i>Drosophila Melangaster</i></i>		
120	Youngwook Kim	GM - Athletic Training	Jenna Yentes
	<i>Effects of Height Increasing Heel Insole on Lower Extremity Joint Mechanics</i>		

#	STUDENT	PROGRAM	ADVISOR
201	Devika Ramachandran	GM - Biomedical Informatics	Ann Fruhling
	<i>Evaluation of Effective Authentication Methods for Patient Health Records</i>		
203	Monica Malchow	UG - Psychology	Roni Reiter-Palmon
	<i>Creativity and Self-Reports</i>		
205	Mason Schleu	UG - Computer Science	Brian Knarr
	<i>Quantifying Static and Dynamic Stability Using Mobile Sensors</i>		
207	Jason Hornberg	GD - Psychology	Roni Reiter-Palmon
	<i>Task Experience as a Mediator in the Relationship between Task Interest and Creative Solutions</i>		
209	Allison Hoover	UG - Exercise Science	Mukul Mukherjee
	<i>The Effect of Bilateral Vestibular Stimulation on Locomotor Adaptation</i>		
211	Skylar Muller	UG - Biology	Rosemary Strasser
	<i>Behavior of Zoo Visitors and their Attitudes Towards Zoo Animals</i>		
213	Caleb Ross	GM - Exercise Science	Dustin Slivka
	<i>Effects of Hypobaric and Normobaric Hypoxia on Myogenic and Proteolytic Gene Expression in Humans</i>		
215	Jordan Freeman	UG - Physical Education	Jenna Yentes
	<i>An investigation into the correlation between step width variability and balance deficits in patients with chronic obstructive pulmonary disease</i>		
217	Kristen Cunningham	GM - Psychology	Rosemary Strasser
	<i>Hormonal Synchronization between Therapy Dogs and their Handlers</i>		
219	Angeline Helseth Roth	GD - Gerontology	Julie Boron
	<i>Effects of Dual Tasking on Auditory Selective Attention in Three Different Environments</i>		

#	STUDENT	PROGRAM	ADVISOR
801	Jennifer Lee	UG - History	Martina Saltamacchia
	<i>Medieval Currency Conversion Calculator</i>		
802	AnneMarie Little	GM - School Psychology	Lisa Kelly-Vance
	<i>Homework, Organization, & Planning Skills: Helping Students Help Themselves</i>		
803	Joel Elson	GD - Information Technology	Doug Derrick
	<i>Quantifying Uncertainty</i>		
804	Lauren Bowman	UG - Exercise Science	Mukul Mukherjee
	<i>The effects of optic flow on locomotor symmetry</i>		
805	Farahnaz Fallah Tafti	GM - Biomechanics	Jenna Yentes
	<i>Dual-Tasking and the effect of short-term training on risk of falling in patients with COPD</i>		
806	Ali Al Kadhim	UG - Physics	Renat Sabirianov
	<i>Designing novel nanostructured permanent magnets</i>		
807	Jeffrey Patterson	GD - Exercise Science	Kota Takahashi
	<i>Does the Continuity between the Achilles Tendon and the Plantar Fascia Influence Foot and Ankle Power Production?</i>		
808	Elizabeth Oduwo	UG - Neuroscience	Bruce Chase
	<i>Genetic Variants Contributing To Frontotemporal Dementia With Parkinsonism</i>		
809	Megan McGuffey	GD - Public Administration	Bryce Hoflund
	<i>Food and the Urban Policy Agenda: Understanding the Innovators</i>		
810	Boman Groff	UG - Neuroscience	Brian Knarr
	<i>Movement variability and sensorimotor cortical activation during backward and forward walking</i>		
811	Samantha Sack	UG - Biomechanics	Brian Knarr
	<i>Design of an instrumented cane for real-time force feedback</i>		

#	STUDENT	PROGRAM	ADVISOR
812	Adithi Deborah Chakravarthy	GD - Computer Science	Mahadevan Subramaniam
	<i>Correction of Perceived Visual Distortions Using a Software Application and Correlation to Retinal Changes in Eyes with Age-Related Macular Degeneration</i>		
813	Angela Adams	UG - Psychology	Rosemary Strasser
	<i>Courting Behavior among Biparentally and Uniparentally Raised Zebra Finches</i>		
814	Brianna Conway	GM - Psychology	Lisa Kelly-Vance
	<i>Relationships Between Military Deployment and Child Behavior</i>		
815	Lauren Drelicharz	GM - School Psychology	Brian McKeivitt
	<i>An Analysis of Teacher Perceptions of Student Behavior and Discipline in Schools Implementing PBIS</i>		
816	Rachel Miller	UG - Chemistry	Douglas Stack
	<i>Could ortho-aminoquinones of estrogen metabolites serve as platforms for redox cycling?</i>		
817	Roksana Zak	GD - Exercise Science	Dustin Slivka
	<i>The effect of hypoxia on PGC-1</i>		
818	Allison Intorre	UG - Psychology	Jeffrey French
	<i>The Roles of Oxytocin and Vasopressin in Modulating Caregiver Responses to Juvenile Marmoset Monkeys</i>		
819	Zachary Darwish	GM - Psychology	Rosemary Strasser
	<i>Who's Tweeting Whom: The Influence of Rearing Condition on Social Integration in Zebra Finches</i>		
820	Madison Schoenbeck	GM - Psychology	Roni Reiter-Palmon
	<i>Exploring Alternatives to Youth Detention in Douglas County</i>		
821	Prokopios Antonellis	GD - Exercise Science	Philippe Malcolm
	<i>Effects of Ankle Exoskeleton Power and Actuation Timing on Movement Variability and Metabolic Cost of Walking</i>		



INDEX OF PARTICIPANTS

Ammar Abid (14)	Jenna Christiansen* (29)	Sharon Genoways* (16)	Amelia Lanier (29)	Naresh Pasupuleti (26)	Kailey Snyder* (29)
Angela Adams* (37)	Brooks Coleman (31)	Gabrielle Gergen^ (18)	Jennifer Lee** (36)	Tyler Patterson (30)	Doug Stahlnecker (23)
Ali Al Kadhim* (36)	Brianna Conway (37)	Kaitlin Goettsch* (29)	Taylor Leeder (26)	Jeffrey Patterson (36)	James Stanton* (24)
Mohan Sai Ambati (19)	Zechariah Craig* (30)	Angel Gonzalez (32)	Shane Lentz* (28)	Trevor Pentzien* (34)	Donald Steffensmeier (13)
Samuel Anderson* (34)	Kristen Cunningham* (32, 35)	Alexander Goodman (34)	Qianran Li (29)	Lydia Perkins (26)	Kathleen Stibbs (31)
Christina Angeli (29)	Rebecca Cuthbert (27)	Austin Gowen* (12)	Sydney Lintner (23)	James Pierce (23)	Molly Sullivan (24)
Prokopios Antonellis (37)	Nicky Dalbir (33)	Boman Groff* (36)	AnneMarie Little (36)	Mithra Pirooz (15)	Nishchala Tangirala* (27)
Kristi Apa (25)	Shawn Daley (24)	Jeremy Gutierrez* (16)	Michael Logan* (14)	Kelly Prange (25, 26)	KayLee Taylor* (24)
Bryon Applequist* (28)	Marcel Daly (17)	Bashayer Hammadi** (27)	Samuel Maaiah** (25)	Amy Proskovec* (24)	Nicholas Than (25)
Alyssa Averhoff (26)	Nicole Damen (19)	John Hare* (30)	Clare Maakstad* (25)	Sofia Rahmanzai (28)	Sheridan Trent* (22)
Matthew Baker (34)	Goodmond Daniels* (34)	Ryan Hartley* (24)	Yara Mahfood Haddad* (15)	Devika Ramachandran* (35)	Abhishek Tripathi* (31)
Sarah Baker (33)	Anjani Devi Danthuluri* (33)	Benjamin Hayworth** (17)	Monica Malchow* (35)	Troy Rand (19)	Michelle Tully (28)
Robert Barber (32)	Zachary Darwish (37)	Abi Heller** (17, 32)	Michaela Marian (23)	Elham Rastegari (16, 20)	Srikanth Vadla (14, 26, 32)
Jessica Bargstadt* (30)	Jose Davila (33)	Kelly Helmer (31)	Matthew Martens** (16)	Samuel Ray* (15)	Bradon Valgardson* (16)
Laurie Barry* (12)	Jacquelyn Davis (18)	Angeline Helseth Roth* (36)	Louis Martin (30)	Connor Reed* (31)	Ursula VanAntwerp* (14)
Ellyn Bass* (33)	Lily DeFrank (18)	Stephanie Hengen (28)	Shane McDermott (14, 26, 32)	Jessica Rerucha* (24)	Sandra Vargas-Salinas (17)
Sidney Baudendistel (24)	Joseph Devlin^ (12)	Jayson Henrickson (31)	Madalyn McFarland* (19)	Nicholas Reynolds* (29)	Srinivasa Keerthy Vishnubhotla (30)
Eagan Behne* (27)	Noah Diaz (12)	Natividad Hernandez (27)	Megan McGuffey* (36)	Andrew Riquier* (14)	Ameen Wahba (12)
Eric Behrens* (14)	Laura Dilley (26)	Tova Hettinger (22)	Zachary Meade* (34)	Jacob Robinson* (17)	Shane Warehime (24)
Hannah Bergwell (27)	Britny Doane (18)	Stephanie Hines* (18)	Doug Meigs* (19)	Chase Rock* (14)	Lauren Wehrle* (29)
Mahmud Bezhani* (23)	Lucas Dolezal (31)	Allison Hoover (35)	Rachel Miller (37)	Caleb Ross (35)	Sean West* (14)
Brandon Bischoff (22)	Lauren Drelicharz (37)	James Hopkins* (32)	Hanna Miller* (18)	Colleen Rothe-Groleau* (30)	Chase Wickard* (16)
Monica Blaser (25)	Drew Dudley (22)	Jason Hornberg (35)	Kevin Mitchell (15)	Heather Rozema* (17)	Connor Wicks (25)
Vidya Bommanapally (14, 26, 32)	Austin Duncan (13)	Joshua Hoxmeier* (20)	Elyssa Monzingo* (27)	Jacalyn Russ (34)	Jordan Wickstrom* (14)
Cori Borgheiinck (33)	Patrick Dunlap (40)	Grogan Huff* (17)	Madeleine Moore (30)	Danielle Rutz (26)	Jessica Wilson* (12)
Lauren Bowman (36)	Ayan Dutta (15)	Michelle Huffman* (20)	Margaret Moore* (17)	Samantha Sack (36)	Veronica Wolf (34)
Grace Brown** (28)	Christopher Dziatkowski* (27)	Allison Intorre* (37)	Zachary Motz (28)	Olimpiya Saha (13)	Stephanie Womack* (34)
Lindsay Brown* (19)	Maggie Edwards (18)	Joshua Irvin* (32)	Joseph Mroz (22)	Austin Sanford (26)	Harim Won* (16)
Elijah Brown (17)	Joel Elson* (36)	Hilary Jenkins (16)	Skylar Muller* (35)	Natalie Scarpa (22)	Mikayla Woodard (13)
Roland Buchta** (18)	Rebekka Erks* (24, 29)	Timothy Joe* (33)	Quinn Nelson^ (13)	Molly Schieber (28)	Brad Woosley (18)
Morgan Busboom (25)	Farahnaz Fallah Tafti (36)	Christopher Johnson* (22)	Dallas Nelson (12)	Mason Schleu (35)	Henamari Ybay (28)
Alejandro Bustillos* (24)	Brian Felderman (26)	Alli Kolina* (23)	Reo Newring (32)	Madison Schoenbeck (37)	Michael Yoerger* (23)
Alicia Buttner* (19, 30)	Abigail Folberg* (23, 27)	Esther Kapinga* (29)	James Nielsen* (31)	Thomas Schulze (26)	Aaron Young* (30)
Casey Caniglia* (17)	Jordan Freeman* (35)	Jenny Kent (20)	Erica Nightengale* (19)	Katherine Schwartz* (12)	Roksana Zak (37)
Sarah Carp* (32)	Maeghan Fry* (25)	Ji Seul Kim* (28)	Katlyn Nimtz (33)	Thomas Seguin (15)	
Mark Carter** (29)	Jessica Fujan-Hansen* (32)	Youngwook Kim (35)	Erin Nyquist (24)	Candi Senior-Remsa* (34)	
Jon Cavanaugh* (13)	Julia Fuller* (13)	Suyeon Kim (20)	Elizabeth Oduwo* (36)	Roni Shelly Perez (17)	
Adithi Deborah Chakravarthy (37)	Ryan Galer (20)	Kasey Klatt (31)	Miche Okura (28)	Haley Shelton* (23)	
Li-Dunn Chen* (30)	Venkat Ramana Reddy Garlapati* (15)	Saul Knoblauch (15)	Abderrahman Ouattas (32)	Robert Shute (25)	
Zhiyuan Chen* (31)	Emily Geest* (19)	Grace Kolbo* (17)	Emily Pachunka* (15)	Marvin Sibrian* (25)	
Aditya Chouhan (31)	Taylor Gehringer (33)	Trevor Krzyzanowski* (23)	Nikolaos Papachatzis (22)	Sara Smith^ (22)	
Devin Christensen* (34)		Nicole Landowski* (22)	Sungho Park (20)	Joseph Smolsky* (33)	

NOTES

Lined area for notes on page 42.

Lined area for notes on page 43.

THIS EVENT IS A COLLABORATION OF THE OFFICE
OF RESEARCH AND CREATIVE ACTIVITY, CRISS LIBRARY,
AND THE OFFICE OF UNIVERSITY COMMUNICATIONS.

research.unomaha.edu/fair

OFFICE OF RESEARCH AND CREATIVE ACTIVITY
203 Eppley Administration Building
6001 Dodge Street | Omaha, NE 68182
402.554.2286 | unoorca@unomaha.edu

The University of Nebraska at Omaha shall not discriminate based upon age, race, ethnicity, color, national origin, gender-identity, sex, pregnancy, disability, sexual orientation, genetic information, veteran's status, marital status, religion, or political affiliation. 0348PRGMORCA0116

UNIVERSITY OF
Nebraska
Omaha

